



## Modern Warehouse in Central Location!

- 9,600 SF total
- 2,188 SF office
- 22' 6" clear height
- 2 dock-high doors
- 1 ramped drive-in door
- Immediate interstate access and visibility

## For more information:

Zach Hubbard, SIOR  
816.932.5504  
zhubbard@blockllc.com

Blaise Gunnerson  
816.878.6314  
bgunnerson@blockllc.com

The information contained in this marketing flyer is presented as general information only. Block Real Estate Services, LLC makes no representation as to its accuracy. This information is not intended as legal, financial or real estate advice and must not be relied upon as such. You should make your own inquiries, obtain independent inspections, and seek professional advice tailored to your specific circumstances before making any legal, financial or real estate decisions.

## Building Specifications

AVAILABLE AREA: 9,600 SF

OFFICE: 2,188 SF

BUILDING AREA: 48,260 SF

YEAR BUILT: 1997

CEILING HEIGHT: 22' 6"

LOADING: Two (2) Dock-High Doors (9'X10') with Manual Pit Levers  
One (1) Drive-In Door (9'X10'), Ramped

COLUMN SPACING: 40' x 40'

SPRINKLER: Wet

ELECTRIC SERVICE: 200 amp, 277/480v, 3-ph

TYPE OF LEASE: Net, Net

OFFERING RATE: \$7.25 PSF

NET CHARGES: (Est. 2024)	CAM:	\$1.19 PSF
	Taxes:	\$1.42 PSF
	<u>Insurance:</u>	<u>\$0.22 PSF</u>
	Total:	\$2.83 PSF

### For more information:

Zach Hubbard, SIOR  
816.932.5504  
zhubbard@blockllc.com

Blaise Gunnerson  
816.878.6314  
bgunnerson@blockllc.com

## Suite Floor Plan

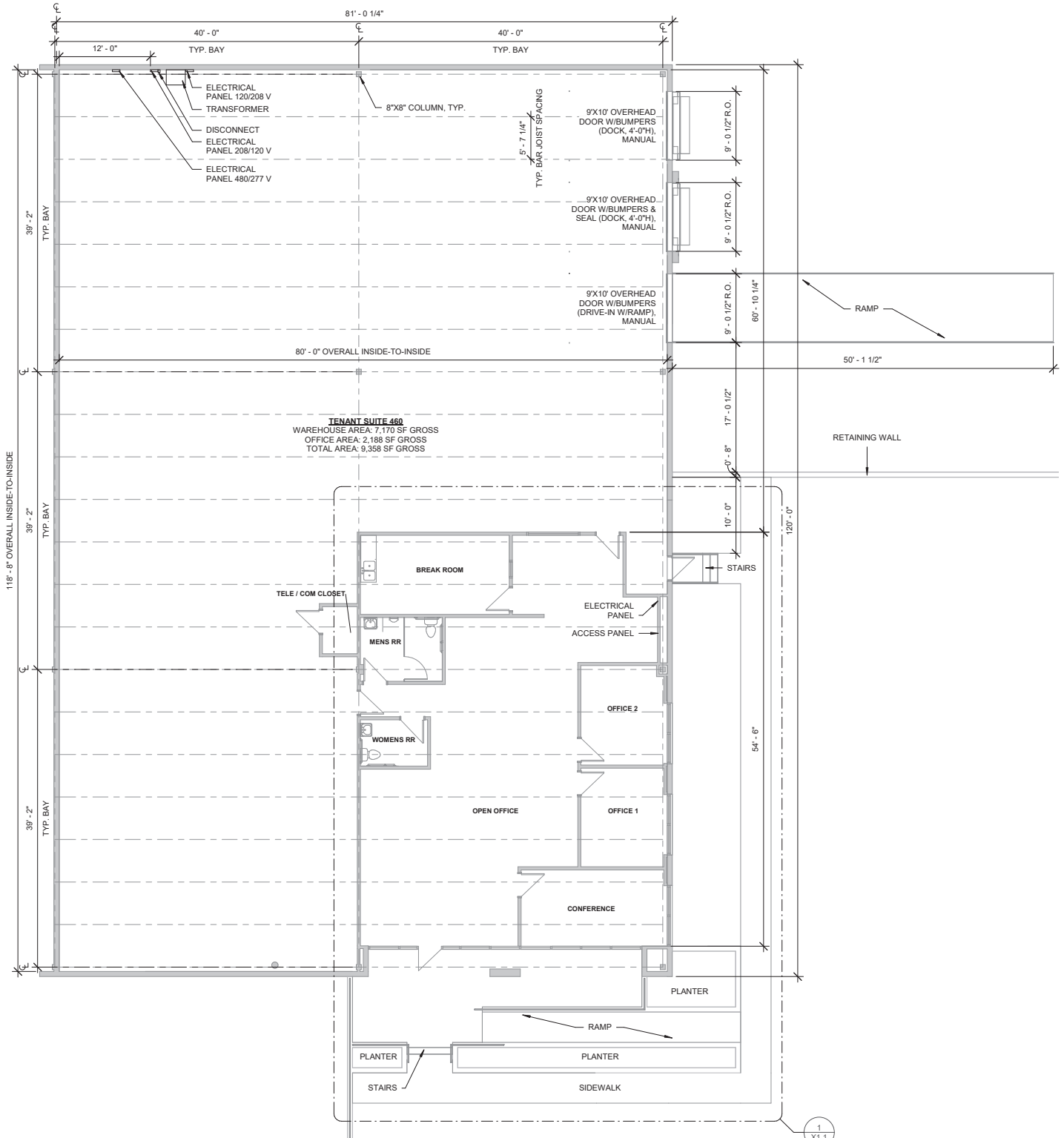

## Office Floor Plan

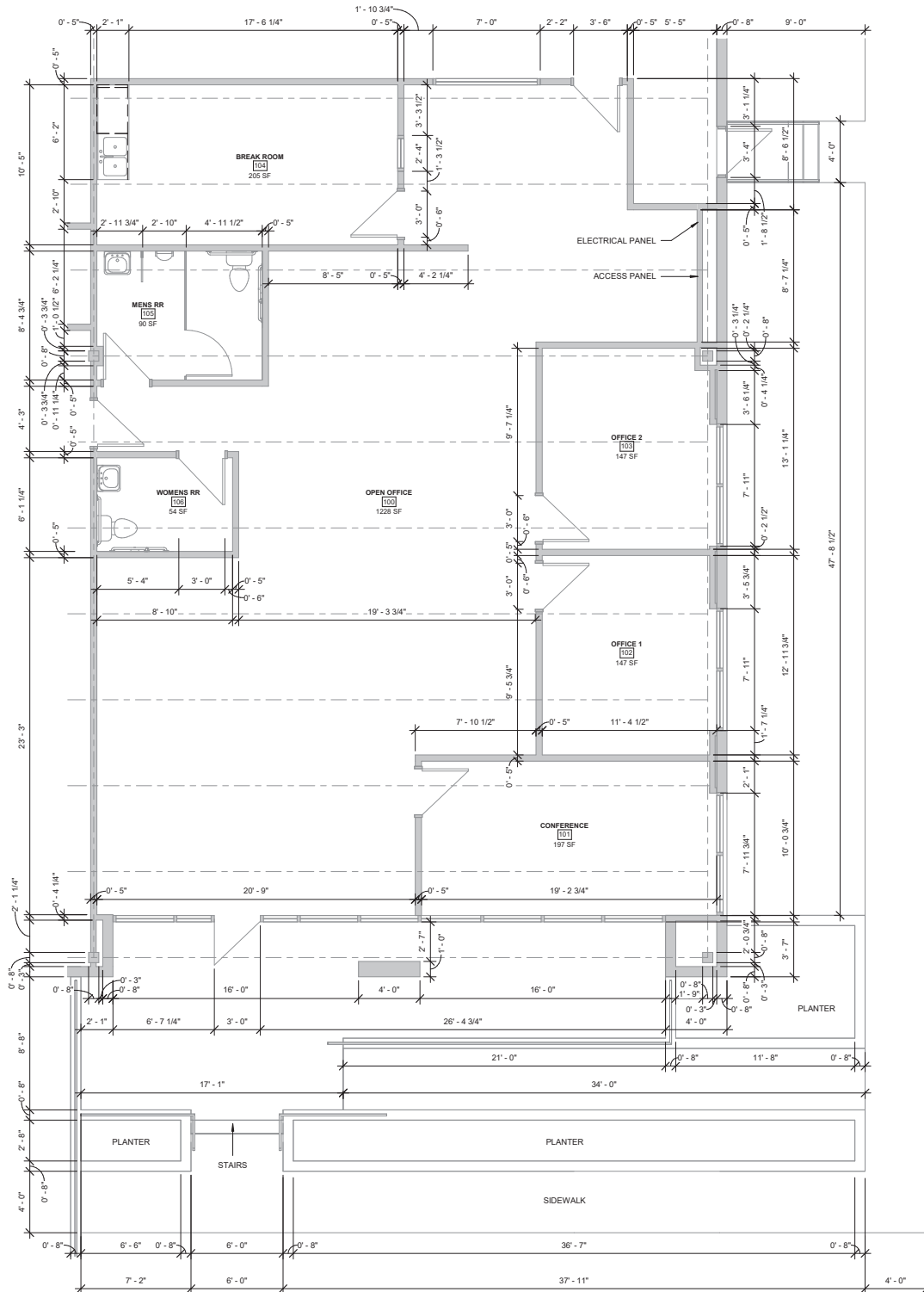

# Platte Valley Industrial Center #10

460 NW Parkway, Riverside, Missouri

# For Lease

Site Plan

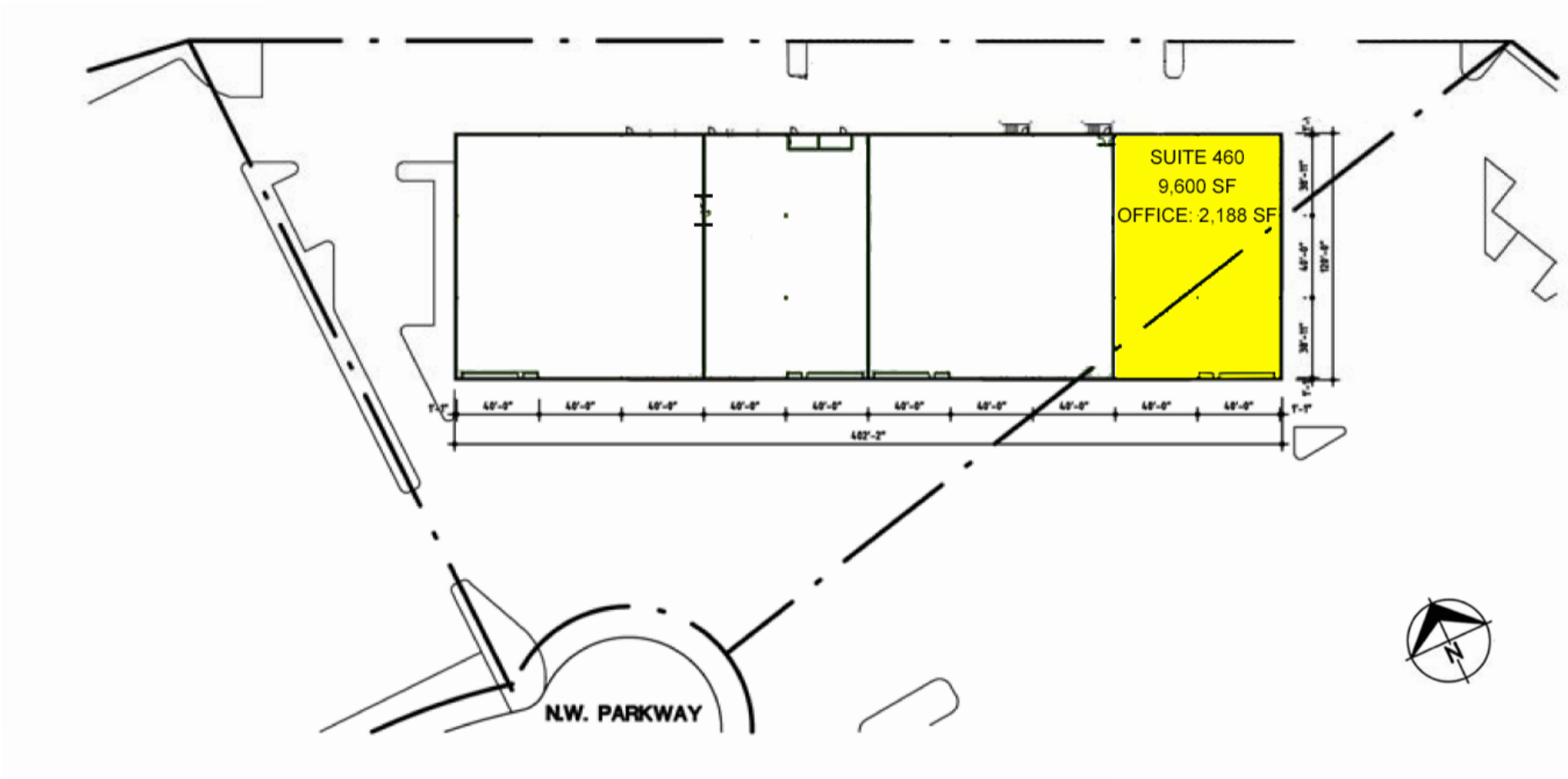

# Platte Valley Industrial Center #10

460 NW Parkway, Riverside, Missouri

# For Lease

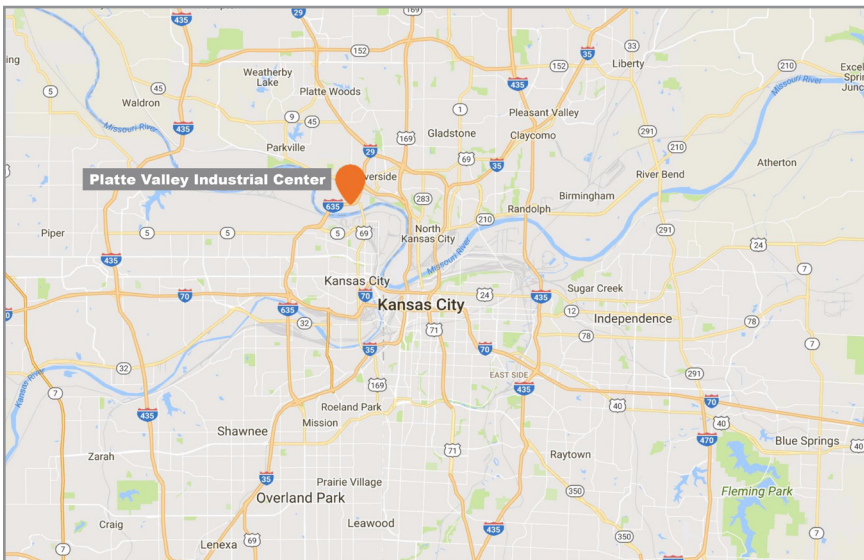

For more information:

Zach Hubbard, SIOR  
816.932.5504  
zhu Hubbard@blockllc.com

Blaise Gunnerson  
816.878.6314  
bgunnerson@blockllc.com

4622 Pennsylvania Ave., Suite 700  
Kansas City, MO 64112  
816.756.1400 | www.BLOCKLLC.com

**BLOCK**  
REAL ESTATE SERVICES, LLC