

Platte Valley Industrial Center #3

614 NW Platte Valley Dr, Riverside, MO 64150

For Lease



Excellent Site!

- 4,608 SF Total
- 850 SF Office
- I-35, I-29, I-635, & Hwy-9 Accessible
- Central Location
- 18' Clear Height
- Dock-High & Drive-In Loading

For more information:

Zach Hubbard, SIOR
816.932.5504
zhubbard@blockllc.com

Blaise Gunnerson
816.878.6314
bgunnerson@blockllc.com

The information contained in this marketing flyer is presented as general information only. Block Real Estate Services, LLC makes no representation as to its accuracy. This information is not intended as legal, financial or real estate advice and must not be relied upon as such. You should make your own inquiries, obtain independent inspections, and seek professional advice tailored to your specific circumstances before making any legal, financial or real estate decisions.

Platte Valley Industrial Center #3

614 NW Platte Valley Dr, Riverside, MO 64150

For Lease

Building Specifications

Square Feet Available: 4,608 SF

Office Space: 850 SF

Total Building Square Feet: 55,296 SF

Year Built: 1989

Clear Height: 18'

Loading: 1 Dock, 1 Drive-In (Grade Level)

Column Spacing: 32' x 36'

Floor Type: 6" Slab on Grade

Sprinkler: Wet System

Electric Service: 200 Amp, 120/208 V, 3-Phase

Type of Lease: NNN

Offering Rate: \$7.75 PSF Net

Net Charges (Est. 2025):	CAM:	\$1.12 PSF
	Taxes:	\$1.52 PSF
	<u>Insurance:</u>	<u>\$0.29 PSF</u>
	Total:	\$2.93 PSF

For more information:

Zach Hubbard, SIOR
816.932.5504
zhubbard@blockllc.com

Blaise Gunnerson
816.878.6314
bgunnerson@blockllc.com

Platte Valley Industrial Center #3

614 NW Platte Valley Dr, Riverside, MO 64150

For Lease

Site Plan

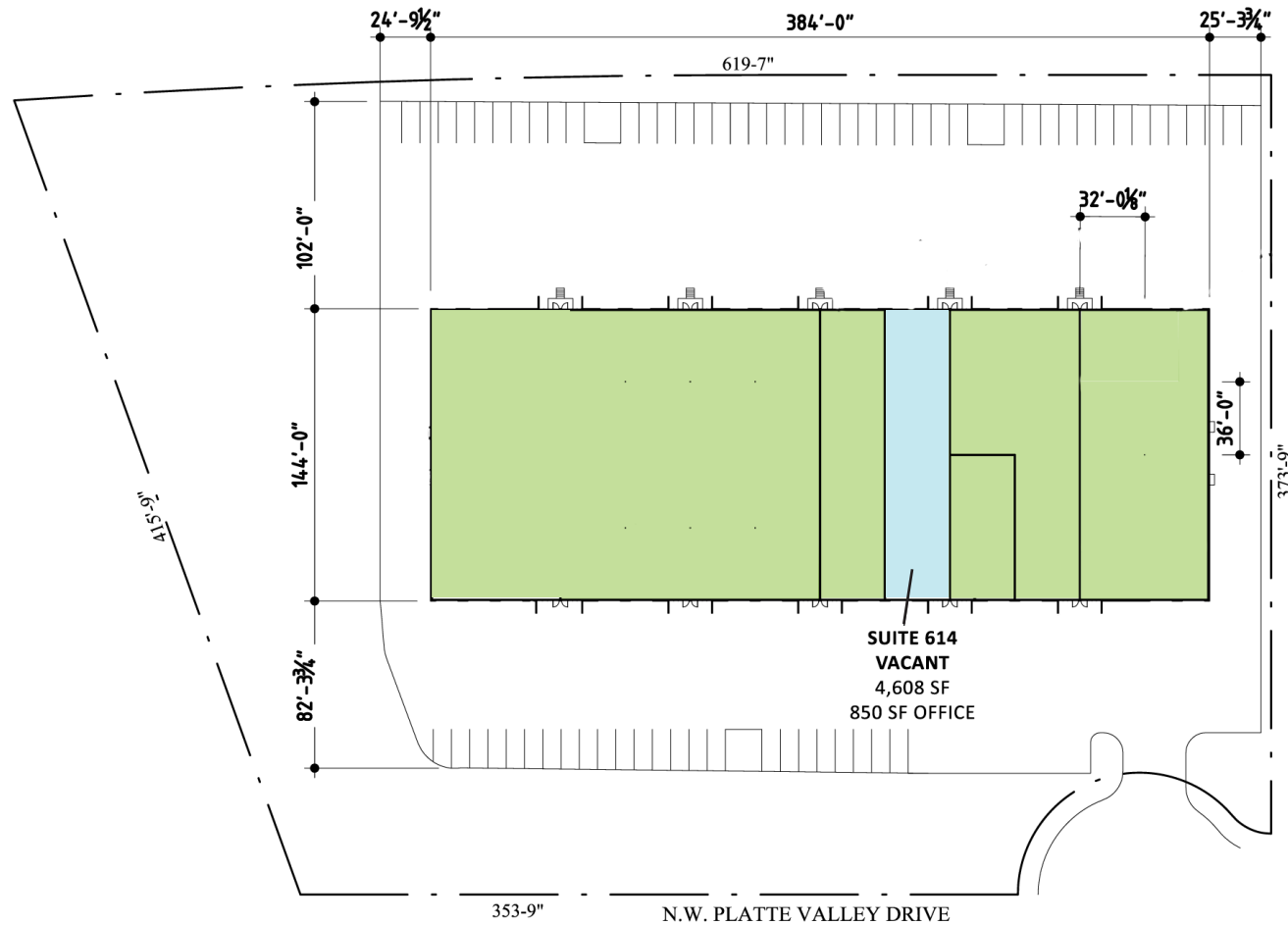

Platte Valley Industrial Center #3

614 NW Platte Valley Dr, Riverside, MO 64150

For Lease

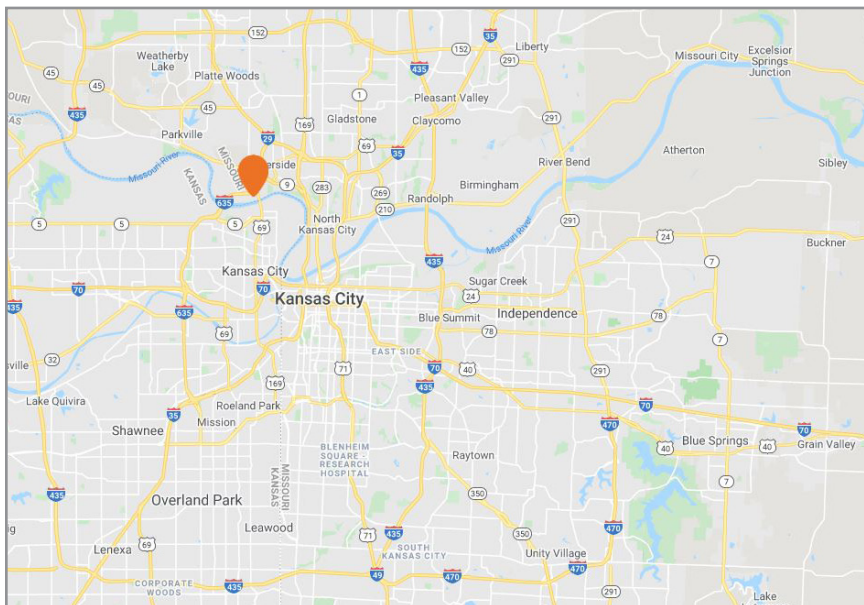
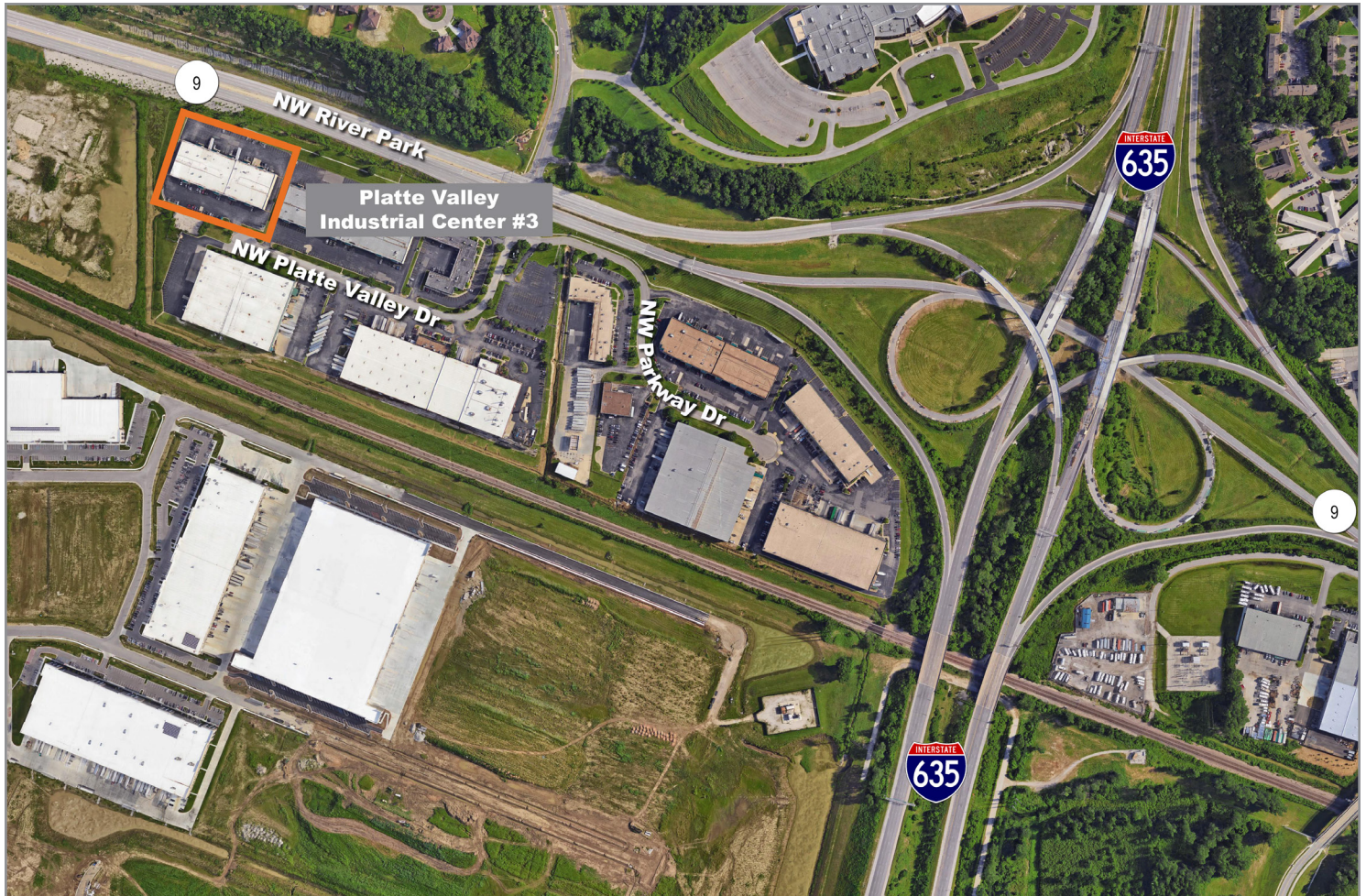

For more information:

Zach Hubbard, SIOR

816.932.5504

zhubbard@blockllc.com

Blaise Gunnerson

816.878.6314

bgunnerson@blockllc.com