

82 Corporate Woods

10851 Mastin Boulevard, Overland Park, Kansas 66210

 **CORPORATE WOODS®**

THE PERFECT PLACE TO GROW.



For more information:

Brent W. Roberts, CCIM

816.932.5520

broberts@blockllc.com

www.corporatewoods.com

Cassidy A. Mears

816.412.5845

cmears@blockllc.com

BLOCK

REAL ESTATE SERVICES, LLC

10880 Benson Drive, Suite 2325

Overlandpark, KS 66210

www.BLOCKLLC.com

82 Corporate Woods

10851 Mastin Boulevard, Overland Park, Kansas 66210

 **CORPORATE WOODS®**

THE PERFECT PLACE TO GROW.

Ninth Floor

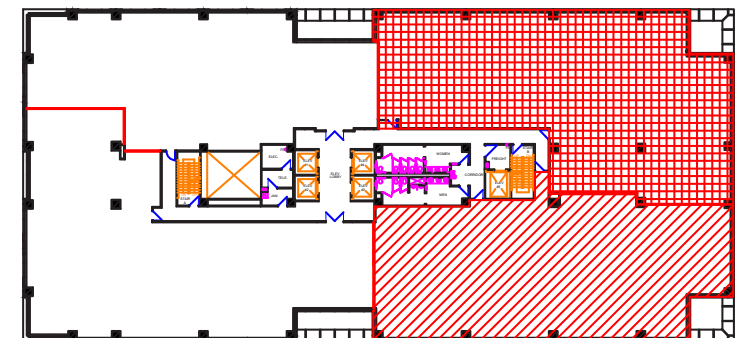
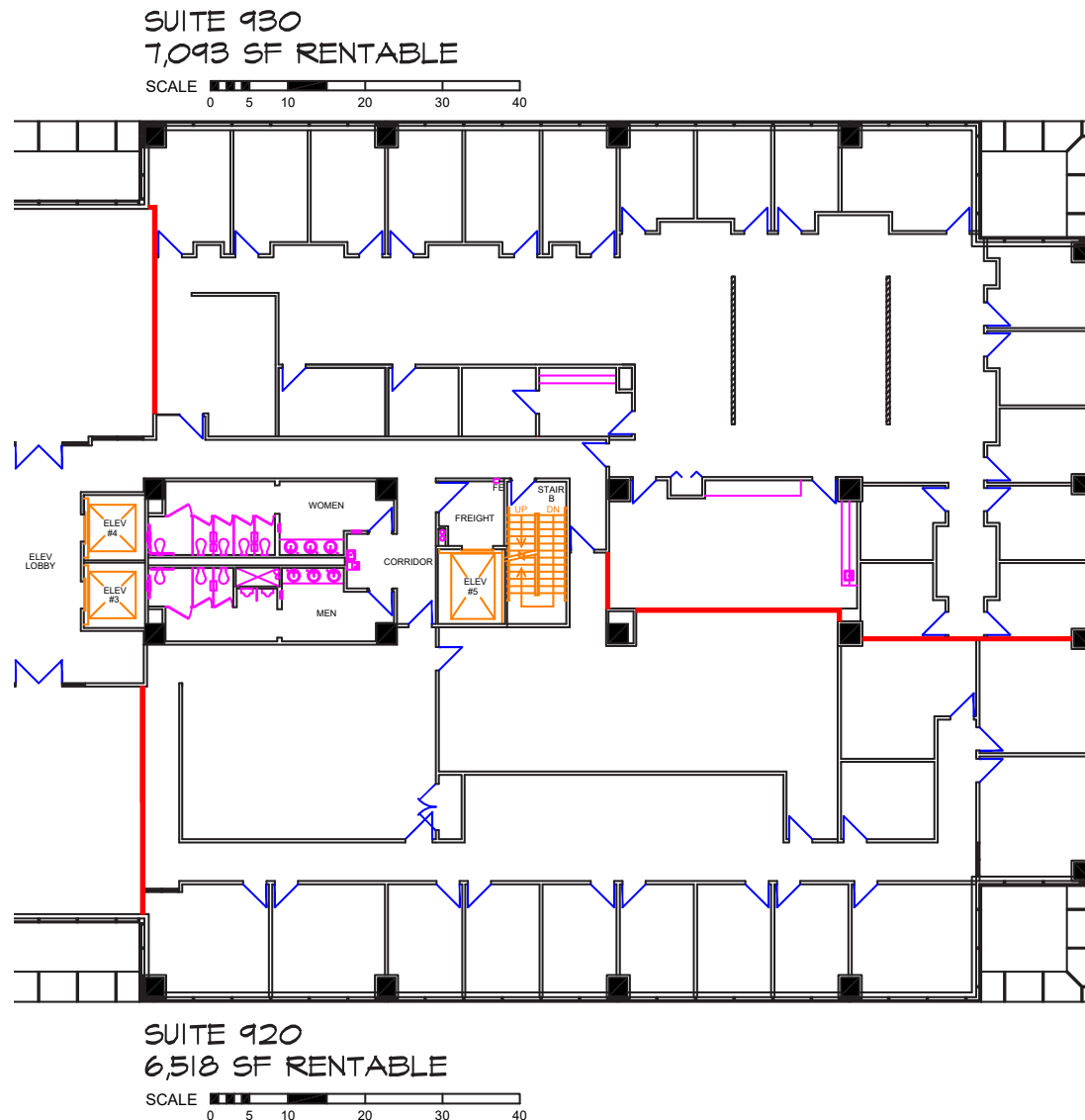

LOCATION ON FLOOR

Combined 9th floor size: 13,611 RSF

10th floor availability: 26,492 RSF

Total contiguous: 40,103 RSF

82 Corporate Woods

10851 Mastin Boulevard, Overland Park, Kansas 66210

 CORPORATE WOODS®

THE PERFECT PLACE TO GROW.

Tenth Floor

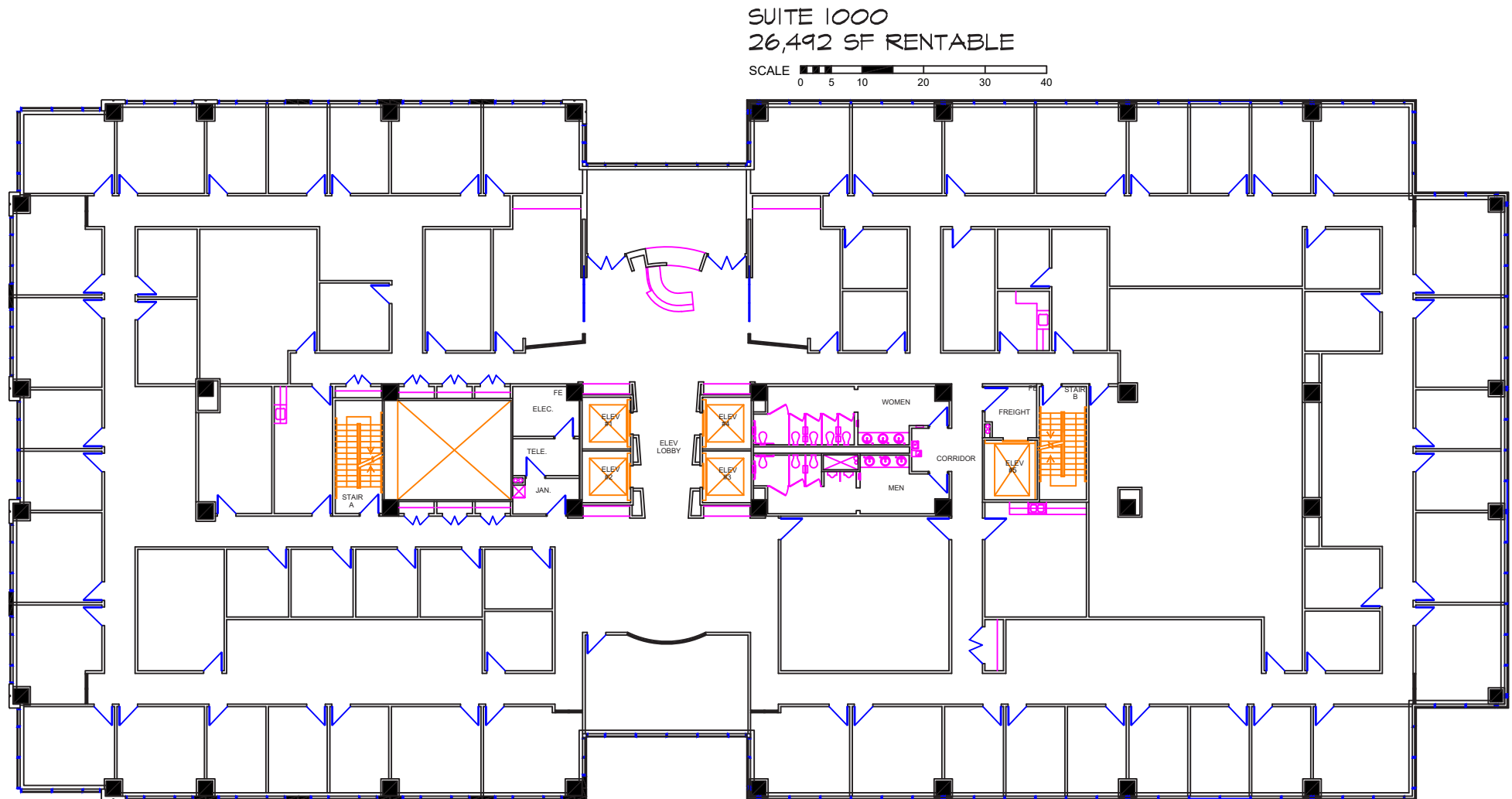

Combined 9th floor size: 13,611 RSF

10th floor availability: 26,492 RSF

Total contiguous: 40,103 RSF

The information contained in this marketing flyer is presented as general information only. Block Real Estate Services, LLC. makes no representation as to its accuracy. This information is not intended as legal, financial or real estate advice and must not be relied upon as such. You should make your own inquiries, obtain independent inspections, and seek professional advice tailored to your specific circumstances before making any legal, financial or real estate decisions.

82 Corporate Woods

10851 Mastin Boulevard, Overland Park, Kansas 66210

 **CORPORATE WOODS®**

THE PERFECT PLACE TO GROW.

Corporate Woods Park Map



The information contained in this marketing flyer is presented as general information only. Block Real Estate Services, LLC. makes no representation as to its accuracy. This information is not intended as legal, financial or real estate advice and must not be relied upon as such. You should make your own inquiries, obtain independent inspections, and seek professional advice tailored to your specific circumstances before making any legal, financial or real estate decisions.