

Lenexa Logistics Centre - E3

16301-16501 West 116th Street, Lenexa, Kansas

For Lease



Excellent Location

- 249,150 SF bulk cross-dock facility
- Modern tilt-wall construction; energy efficient low E reflective glass
- 32' clear height
- Cross-dock loading; 26 - 9'x10' dock-high doors with pit levelers, 31 additional block-outs and 4 - 12'x14' drive-in doors
- Ample customer and employee parking
- Immediate access to I-35, I-435 and Highway K-10
- Energy efficient LED lighting
- ESFR sprinkler system
- Real estate tax abatement PILOT schedule for 10 years!
- [Current Camera Views of Building](#)

For more information:

Kenneth G. Block, SIOR,CCIM
816.932.5551
kblock@blockllc.com

Michael R. Block, CPM
816.932.5549
mblock@blockllc.com

Andrew T. Block
816.412.5873
ablock@blockllc.com

The information contained in this marketing flyer is presented as general information only. Block Real Estate Services, LLC makes no representation as to its accuracy. This information is not intended as legal, financial or real estate advice and must not be relied upon as such. You should make your own inquiries, obtain independent inspections, and seek professional advice tailored to your specific circumstances before making any legal, financial or real estate decisions.

Building Specifications

Address:	16301-16501 West 116th Street, Lenexa, Kansas 66219
Size:	249,150 SF (872' x 280') sitting on 15.8 ± acres of land
Bay Size:	65' x 54'6" at speed bays and in storage areas 50' x 54'6"
Clear Height:	32'
Floor Thickness:	Floors are 7" un-reinforced, 4,000 PSI concrete on 4" of compacted granular fill
Warehouse Heating:	3 Make-up Air Units (MAU) that are evenly spaced at the ridge of the roof with a design criteria to provide 50 degrees inside temperature at 0 degrees outside temperature
Fire Sprinkler:	ESFR fire protection per NFPA-13. Design is based on a flow test of 76 PSI static, 72 PSI residual flowing at 1,300 GPM. It is designed for ESFR protection of Class I-IV commodities stored to a maximum storage height of 35' and a maximum deck height of 40'.
Roof Membrane:	45 mil TPO mechanically fastened roof system with R-20 insulation
Warehouse Lighting:	LED hi-bays to 25 ft candles A.F.F. on average
Warehouse Insulation:	Walls are R-11 stick-pin from 12' A.F.F. to the underside of the roof deck, and roof is R-20.
Internet and Voice Access	This is a prime corridor as Renner Boulevard has fiber in the street that connects to the sonet ring for the entire KC metro area. The copper provider is AT&T, while other fiber providers are: AT&T, T-Mobile, TW Telcom, Zayo Fiber, and Spectrum. Most providers can provide service to this building/park, as there is "Dark Fiber" in the street as well. Cable is provided by Spectrum.
Exterior Lighting:	Exterior lighting is provided on both the building and on poles in the loading and parking areas.
Electric Service:	The total service to the building will be 3,000 amps of 277/480 volt 3-phase with a house panel of 400 amps of 277/480 volt

Building Specifications

Loading:

- 26 - 9’x10’ dock-high doors with pits at all locations and 45,000-lb. Mechanical levelers with dock seals, bumpers and dock lights with receptacles
- 31 additional block-outs for future dock doors
- Dock-hi and drive-in doors will be insulated and each will have a vision panel
- 12’ wide x 14’ tall drive-in doors at the 4 corners of the building

Dock Equipment:

45,000# mechanical pit levelers, dock seals, LED swing-arm dock lights, 2” insulated steal hi-lift dock doors with door perimeter weather stripping

Truck Court:

135’ on both the north and south side

Parking:

363 cars

Zoning:

BP-2 Planned Manufacturing

Utilities:

Natural Gas: Atmos Energy
Water: WaterOne
Electricity: KCP&L
Sewer: Johnson County Wastewater

Net Charges:
(2024 Estimates)

CAM: \$0.95
INS: \$0.17
RE TAXES*: \$0.72
Total: \$1.84

*RE Taxes:

*Real Estate taxes are estimated based upon 1) Fixed PILOT payments per a negotiated abatement agreement with the City of Lenexa; 2) Other tax levies and specials that are not eligible for abatement; and 3) the estimated maximum Special Benefit District (SBD) payment(s) assessed against the property.

Note:

Interchange improvements at I-35 and 119th Street will be made to help ease congestion. The overpass will become a diverging diamond, allowing for traffic flow and safety enhancements. Travel lanes will also be added on 119th Street and turn lanes will be added to I-35 exit ramps.

Lenexa Logistics Centre - E3

16301-16501 West 116th Street, Lenexa, Kansas

For Lease

Building 3 Floor Plan

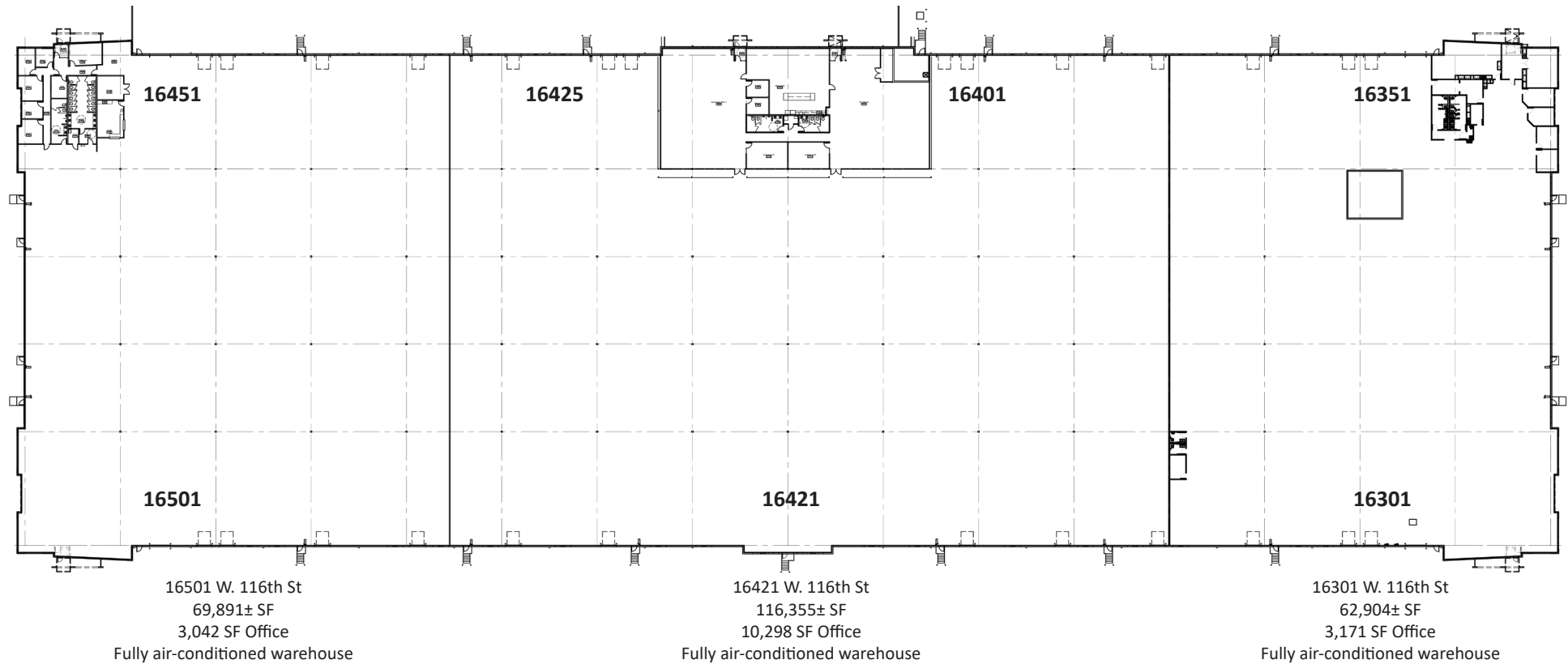

Lenexa Logistics Centre - E3

16301-16501 West 116th Street, Lenexa, Kansas

For Lease

Site Plan

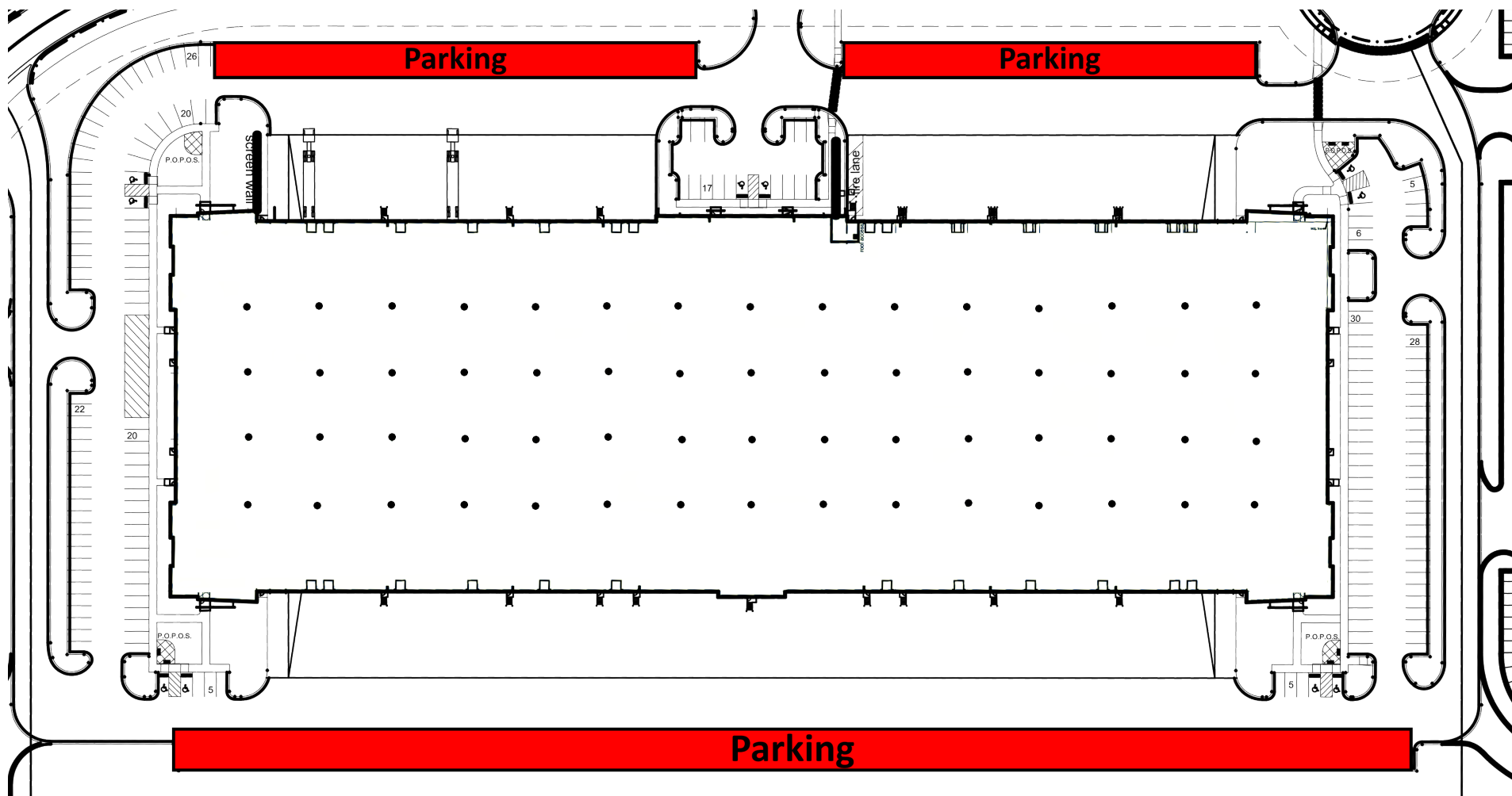

4622 Pennsylvania Avenue, Suite 700
Kansas City, MO 64112
816.756.1400 | www.BLOCKLLC.com

BLOCK
REAL ESTATE SERVICES, LLC

Lenexa Logistics Centre - E3

16301-16501 West 116th Street, Lenexa, Kansas

For Lease

Proposed Preliminary Plans

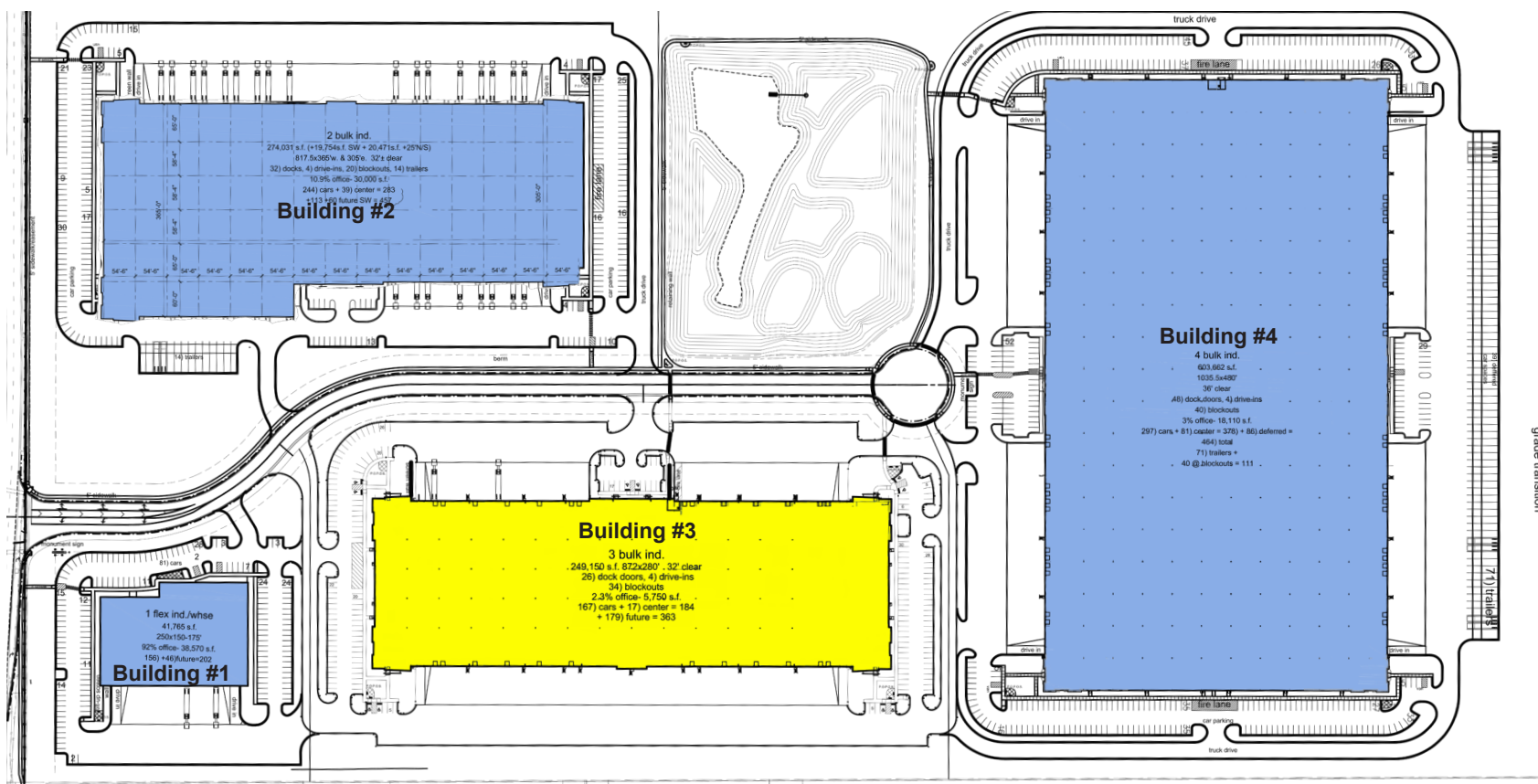

1. Flex Industrial/Warehouse	41,765 SF, 250'x150-175', Single Tenant - Construction BTS/TBS-Land for Sale
2. Bulk Industrial	274,031 SF, 817.5'x365', 32' clear, 28 dock doors, 4 drive-ins, 28 block-outs, Multi-tenant under construction.
3. Bulk Industrial	249,150 SF, 872'x280', 32' clear, 26 dock doors, 4 drive-ins, 34 block-outs, Multi-tenant
4. Bulk Industrial	606,580 SF, 1035.5'x480', 36' clear, 48 dock doors, 4 drive-ins, 40 block-outs, Multi-tenant

16301-16501 West 116th Street, Lenexa, Kansas

LLC East - Site Plan

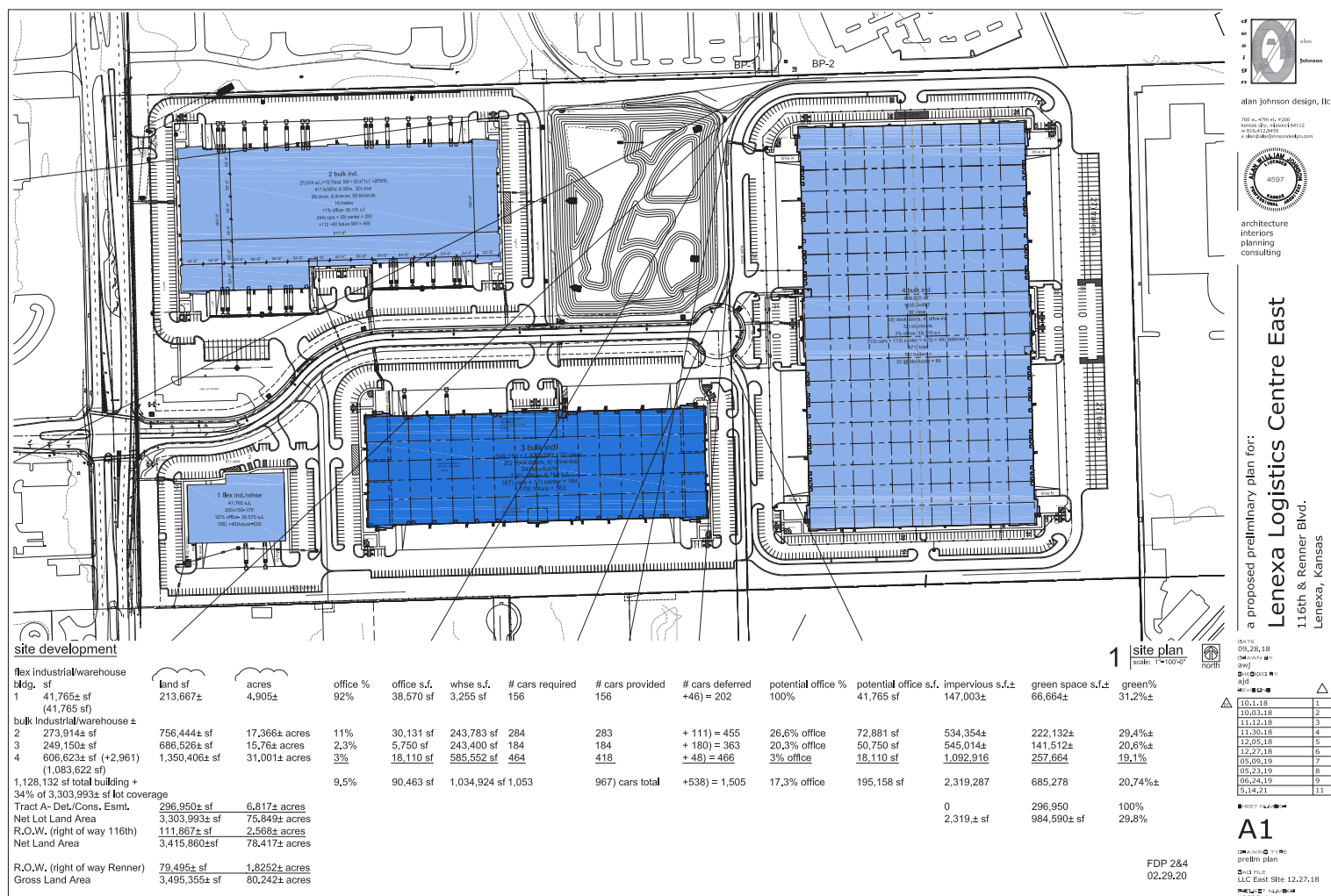

Lenexa Logistics Centre - E3

16301-16501 West 116th Street, Lenexa, Kansas

For Lease

Highway Access / Nearby Interchanges



Lenexa Logistics Centre - E3

16301-16501 West 116th Street, Lenexa, Kansas

For Lease

Lenexa Logistics Centre Development



Lenexa Logistics Centre - E3

16301-16501 West 116th Street, Lenexa, Kansas

For Lease

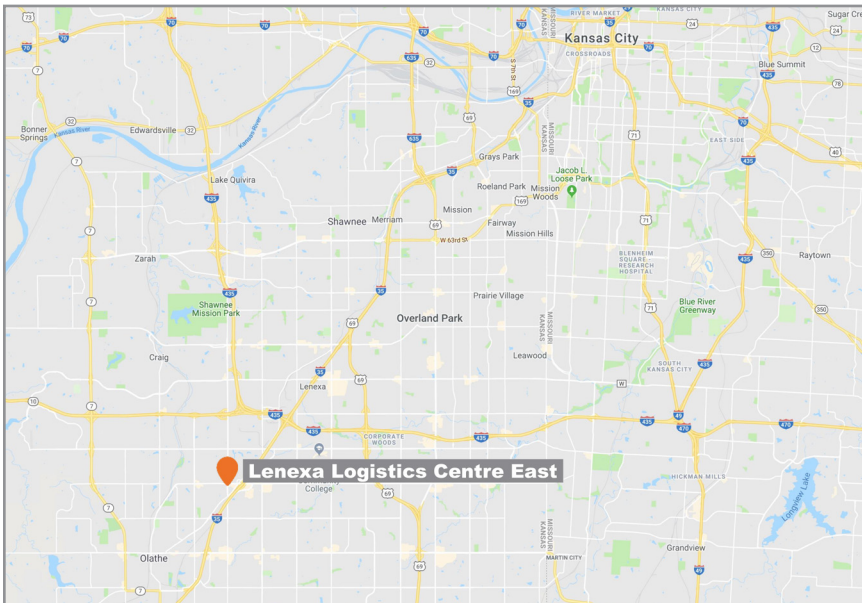

For more information:

Kenneth G. Block, SIOR, CCIM

816.932.5551

kblock@blockllc.com

Michael R. Block, CPM

816.932.5549

mblock@blockllc.com

Andrew T. Block

816.412.5873

ablock@blockllc.com