

Office/Warehouse at I-35 & Lamar



Excellent Spaces Available with I-35 Visibility

- 10,000 SF warehouse/distribution space available for lease
- Immediate highway access to I-35
- 112,000 cars per day
- Interstate visibility
- Dock-High and Drive-In Loading

For more information:

Zach Hubbard, SIOR
816.932.5504
zhu Hubbard@blockllc.com

Hagen Vogel
816.878.6338
hvogel @blockllc.com

The information contained in this marketing flyer is presented as general information only. Block Real Estate Services, LLC. makes no representation as to its accuracy. This information is not intended as legal, financial or real estate advice and must not be relied upon as such. You should make your own inquiries, obtain independent inspections, and seek professional advice tailored to your specific circumstances before making any legal, financial or real estate decisions.

Building Specifications

Total Available SF:	10,000 SF
Office Area:	1,666 SF (est.)
Total Building SF:	106,285 SF
Year Built:	1978
Total Land Area:	5.5 Acres
Zoning:	P-1, Planned Industrial
Traffic Count:	112,000 cars per day
Construction:	Pre-cast concrete (full height), structural steel, Twin T/Block
Roof-Type:	BUR/Modified
Clear Height:	19'-4"
Sprinkler:	Wet System
Column Spacing:	37'-5" N-S x 33'-4" E-W
Floor Type:	6" - slab on grade
Loading:	<ul style="list-style-type: none">• 2 Dock-High• 1 Drive-In
Truck Court Depth:	140' (est.)
Parking:	173 spaces (building total unassigned)
Net Charges: (2022 Est.)	CAM: \$0.70 PSF INS: \$0.11 PSF <u>TAX: \$1.45 PSF</u> Total: \$2.26 PSF
Lease Type:	Net, Net
Offering Rate:	\$5.00 PSF Net

3122 Floor Plan

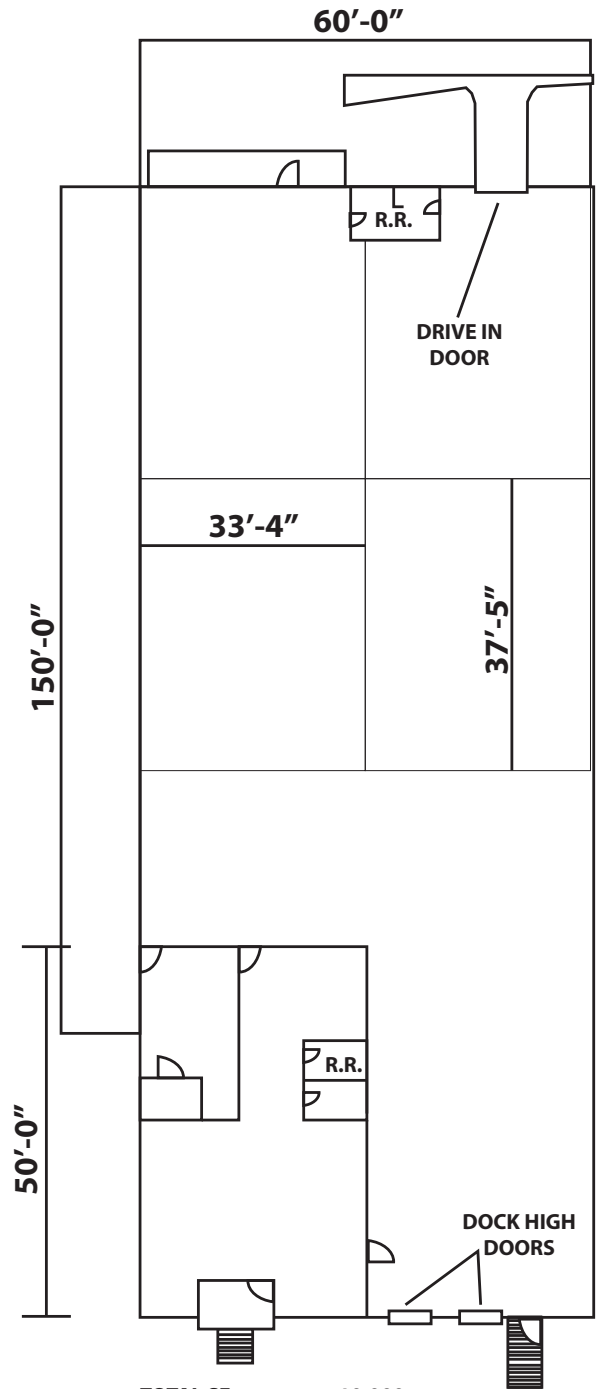

TOTAL SF: 10,000
TOTAL OFFICE SF: 1,666
DRIVE-IN DOOR: 1
DOCK-HIGH DOOR: 2
CEILING HEIGHT: 19' 4"



Lamar Distribution Center

3122 South 24th Street, Kansas City, Kansas

For Lease

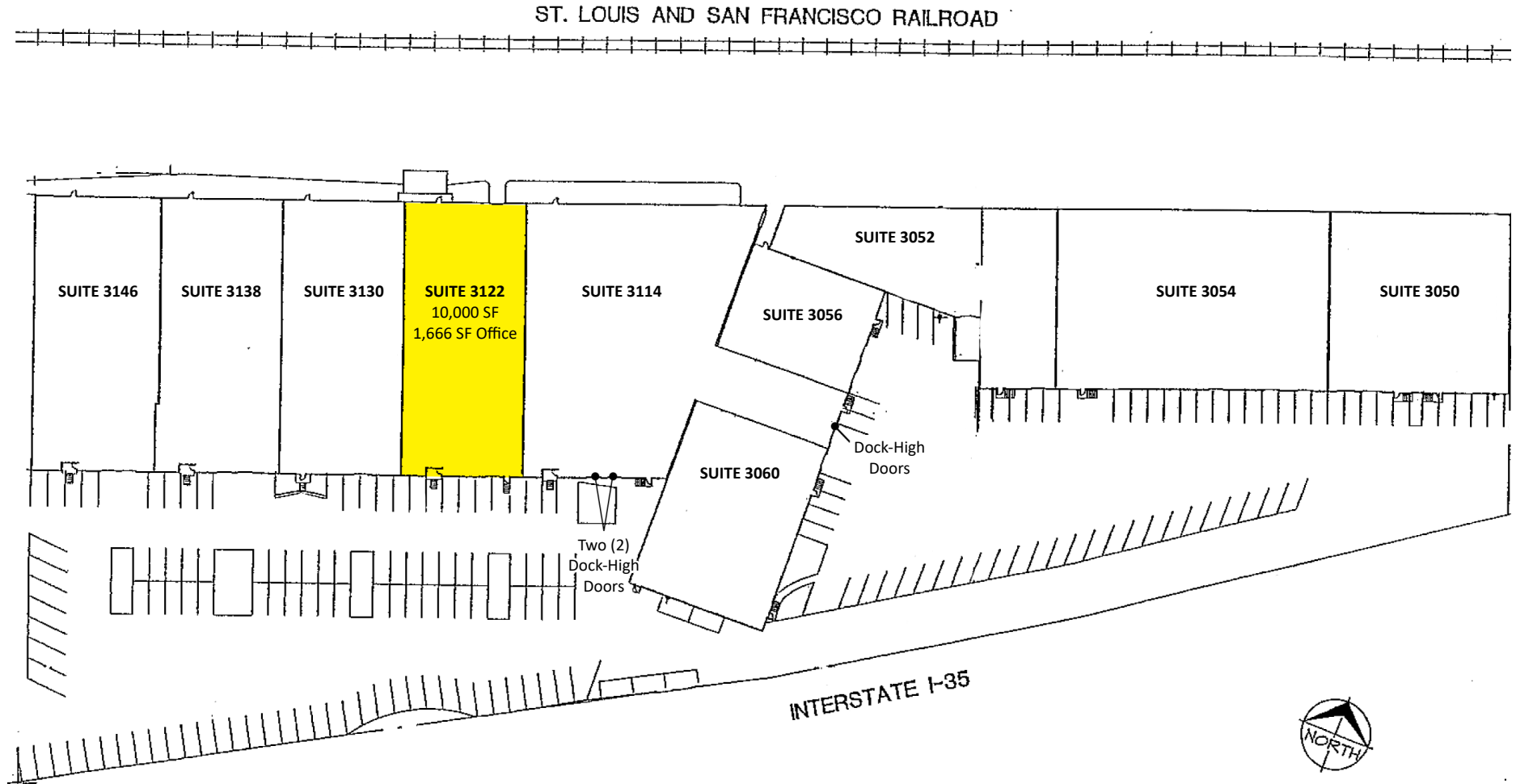

4622 Pennsylvania Avenue, Suite 700
Kansas City, MO 64112
816.756.1400 | www.BLOCKLLC.com

BLOCK
REAL ESTATE SERVICES, LLC

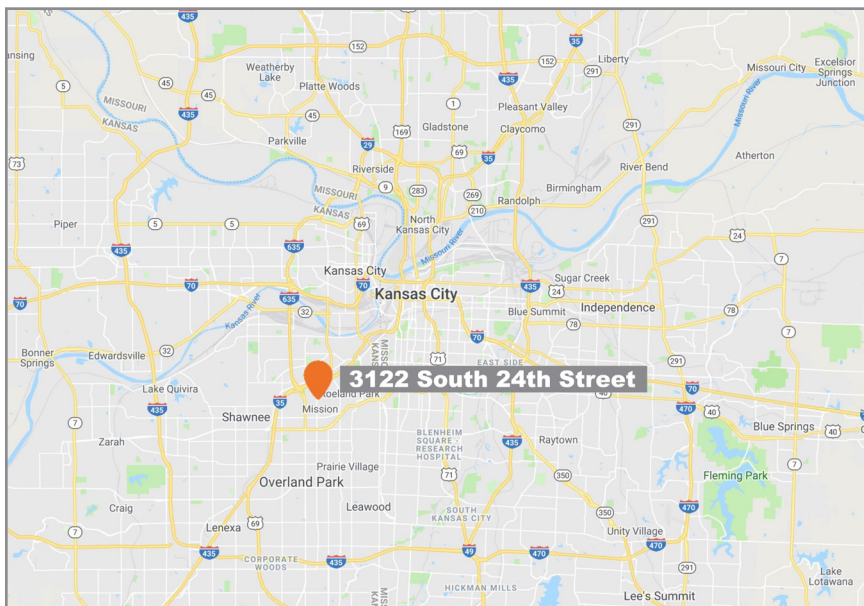

For more information:

Zach Hubbard, SIOR
816.932.5504
zhubbard@blockllc.com

Hagen Vogel
816.878.6338
hvogel@blockllc.com