



### **Excellent access and location Situated in the highly-desirable Johnson County submarket**



#### Prestigious Mixed-Use Business Park

- Excellent access and location in the highly-desirable Johnson County submarket
- 15 minutes from downtown Kansas City and less than 30 minutes from the Kansas City International Airport
- Ample parking which is designed with spaces close to building entrances

#### For more information:

Kenneth G. Block, SIOR, CCIM  
816.932.5551

[kblock@blockllc.com](mailto:kblock@blockllc.com)

Andrew T. Block  
816.412.5873  
[ablock@blockllc.com](mailto:ablock@blockllc.com)

Hagen Vogel  
816.878.6338  
[hvogel@blockllc.com](mailto:hvogel@blockllc.com)

The information contained in this marketing flyer is presented as general information only. Block Real Estate Services, LLC. makes no representation as to its accuracy. This information is not intended as legal, financial or real estate advice and must not be relied upon as such. You should make your own inquiries, obtain independent inspections, and seek professional advice tailored to your specific circumstances before making any legal, financial or real estate decisions.



### General Building Information

<b>Location:</b>	8317-8405 Melrose Drive Lenexa, Kansas
<b>Building Size:</b>	One Story Building 27,206 Square Feet
<b>Parking Ratio:</b>	98 surface spaces. 3.6/1000 SF
<b>Year Constructed:</b>	1984
<b>Building Construction:</b>	Precast concrete
<b>Zoning:</b>	BP-1
<b>Utilities (Lessee):</b>	Electricity - Kansas City Power and Light Gas - KPL Gas Services Water - Water District #1 of Johnson County

#### For more information:

Kenneth G. Block, SIOR, CCIM  
816.932.5551  
kblock@blockllc.com

Andrew T. Block  
816.412.5873  
ablock@blockllc.com

Hagen Vogel  
816.878.6338  
hvogel@blockllc.com

# Building E-2

8317-8405 Melrose, Lenexa, Kansas



Pine Ridge  
Business Park

1,900 SF

**Space Available:** 8331 Melrose Drive  
Lenexa, Kansas

**SF Available:** 1,900 SF Total  
1,043 SF Office  
857 SF Warehouse

**Loading:** 1 Drive-in

**Clear Height:** 16'

**Zoning:** BP-1

**Base Rent:** \$9.00 NNN

**Common Area Maintenance:** \$2.42 PSF (Est.)

**Est. Park Maintenance:** Maximum \$0.6 PSF

**Taxes:** \$2.89 PSF (Est.)

**Insurance:** \$0.35 PSF (Est.)

For more information:

Kenneth G. Block, SIOR, CCIM  
816.932.5551  
kblock@blockllc.com

Andrew T. Block  
816.412.5873  
ablock@blockllc.com

Hagen Vogel  
816.878.6338  
hvogel@blockllc.com

# Building E-2

8317-8405 Melrose, Lenexa, Kansas



Pine Ridge  
Business Park

2,268 SF

**Space Available:** 8335 Melrose Drive  
Lenexa, Kansas

**SF Available:** 2,268 SF Total  
1,680 SF Office  
588 SF Warehouse

**Loading:** 1 Drive-in

**Clear Height:** 16'

**Zoning:** BP-1

**Base Rent:** \$8.50 NNN

**Common Area Maintenance:** \$2.42 PSF (Est.)

**Est. Park Maintenance:** Maximum \$0.6 PSF

**Taxes:** \$2.89 PSF (Est.)

**Insurance:** \$0.35 PSF (Est.)

For more information:

Kenneth G. Block, SIOR, CCIM  
816.932.5551  
kblock@blockllc.com

Andrew T. Block  
816.412.5873  
ablock@blockllc.com

Hagen Vogel  
816.878.6338  
hvogel@blockllc.com

# Building E-2

8317-8405 Melrose, Lenexa, Kansas



Pine Ridge  
Business Park

4,864 SF

**Space Available:** 8339 Melrose Drive  
Lenexa, Kansas

**SF Available:** 4,864 SF Total  
505 SF Warehouse

**Loading:** 2 Drive-ins

**Clear Height:** 16'

**Zoning:** BP-1

**Base Rent:** \$8.25 PSF NNN

**Common Area Maintenance:** \$2.42 PSF (Est.)

**Est. Park Maintenance:** Maximum \$0.6 PSF

**Taxes:** \$2.89 PSF (Est.)

**Insurance:** \$0.35 PSF (Est.)

For more information:

Kenneth G. Block, SIOR, CCIM  
816.932.5551  
kblock@blockllc.com

Andrew T. Block  
816.412.5873  
ablock@blockllc.com

Hagen Vogel  
816.878.6338  
hvogel@blockllc.com



# Building E-2

8317-8405 Melrose, Lenexa, Kansas

## Floor Plan

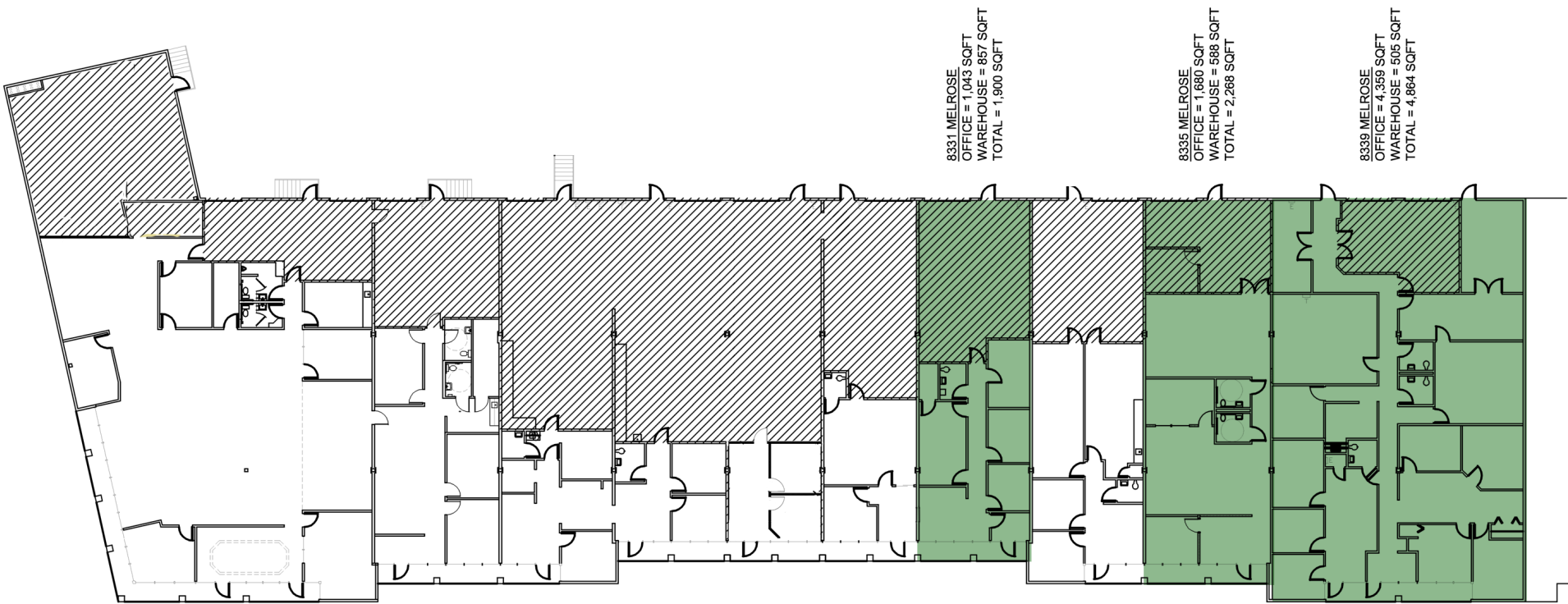

BUILDING E2 – FLOOR PLAN

SCALE: NTS

- WAREHOUSE (W.H.)
- OFFICE