



Excellent Location!

- ±6,078 SF Building On a ±0.53 Acre Lot
- 2 Drive-In Doors
- Heated Warehouse
- Outdoor Storage Available with Secure Gated Access
- Close Proximity to I-49

For more information:

Christian Wead
816.412.8472
cwead@blockllc.com

Blaise Gunnerson
816.878.6314
bgunnerson@blockllc.com

The information contained in this marketing flyer is presented as general information only. Block Real Estate Services, LLC makes no representation as to its accuracy. This information is not intended as legal, financial or real estate advice and must not be relied upon as such. You should make your own inquiries, obtain independent inspections, and seek professional advice tailored to your specific circumstances before making any legal, financial or real estate decisions.

Building Specifications

Building Size:	±6,078 SF (Includes ±576 SF Office Space)
Lot Size:	±0.53 Acres
Year Built:	1986
Loading:	2 Drive-Ins (10' x 10' and 10' x 8')
Clear Height:	11'9"
Electrical:	150A, 240V, 3-Phase
Construction Type:	Steel
Parking:	14 Spaces
Zoning:	M-1
Neighboring Users:	QuikTrip, Hobby Lobby, Paradise Bar & Grill, and more!
Real Estate Taxes (2024):	\$4,544.34 (\$0.75/PSF)
Parcel ID:	05-01-02-400-004-010.000
Legal Description:	LOCUST HILL INDUSTRIAL PARK S158.40' LOT 1

213 Locust Hill Circle

Belton, MO 64012

For Lease

Interior Photos



213 Locust Hill Circle

Belton, MO 64012

For Lease

Exterior Photos



213 Locust Hill Circle

Belton, MO 64012

For Lease

Floor Plan

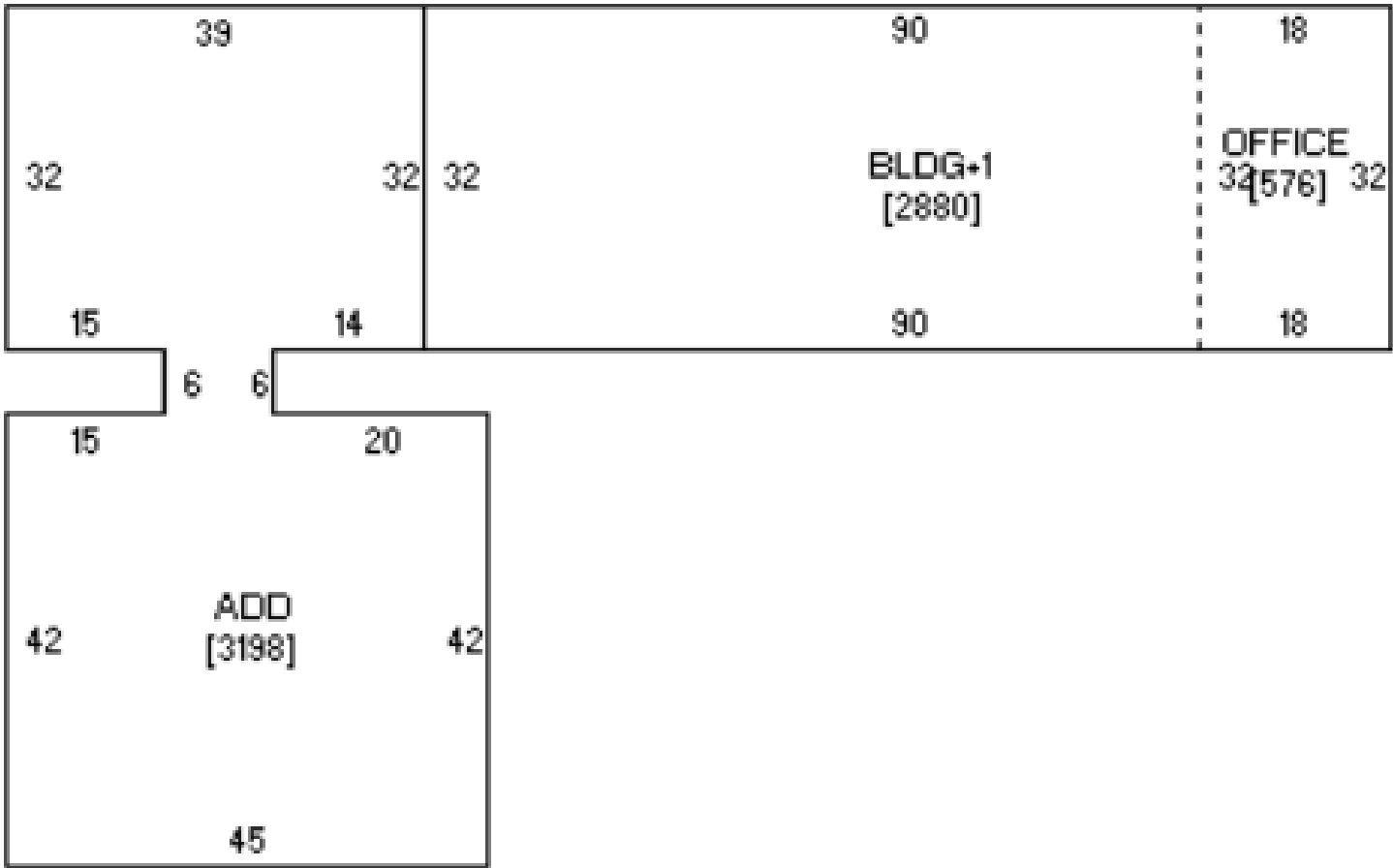

213 Locust Hill Circle

Belton, MO 64012

For Lease

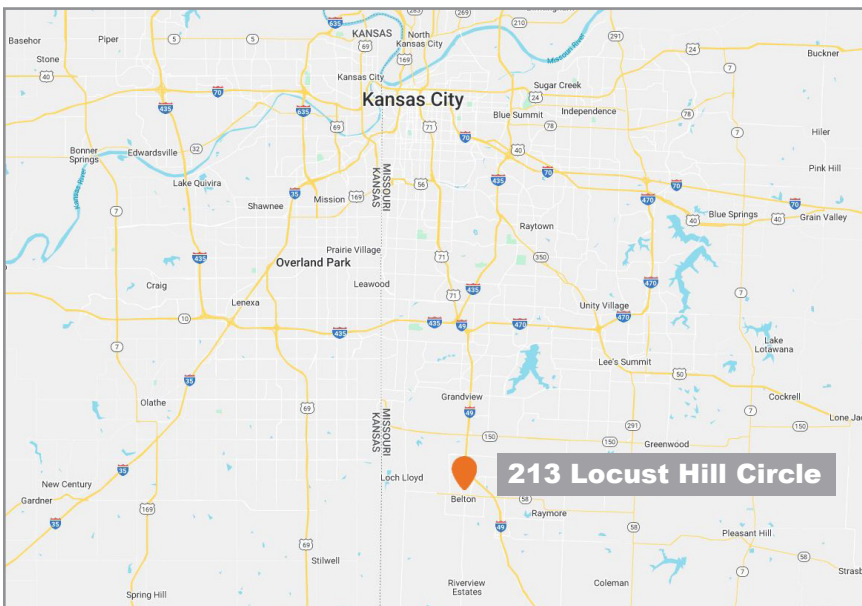

For more information:

Christian Wead

816.412.8472

cwead@blockllc.com

Blaise Gunnerson

816.878.6314

bgunnerson@blockllc.com