

Great Highway Access!

- +/-6 Acre Site
- Existing C-Store and Carwash
- Excellent access to I-35 with visibility to 41,862 cars per day
- Neighboring Users include Quiktrip, Olathe Health, Culver's, Groundhouse Coffee, and more!

For more information:

Christian Wead
816.412.8472
cwead@blockllc.com

Michael R. Block, CPM
816.932.5549
mblock@blockllc.com

The information contained in this marketing flyer is presented as general information only. Block Real Estate Services, LLC. makes no representation as to its accuracy. This information is not intended as legal, financial or real estate advice and must not be relied upon as such. You should make your own inquiries, obtain independent inspections, and seek professional advice tailored to your specific circumstances before making any legal, financial or real estate decisions.

Building Specifications

Property Size: +/-6 Acres

Zoning: C-3; Commercial

Year Built: 2001

Year Renovated: 2016

Gross Building Area: 5,089 SF

Flood Zone: Zone X

Parcel ID: CP78500000 0001

Utilities/Municipal Services: All available to site

Lease: Subway lease in place through 2/28/2025

Parking: 25 surface parking spaces



19000 S Gardner Rd

Gardner, Kansas, 66030

For Sale

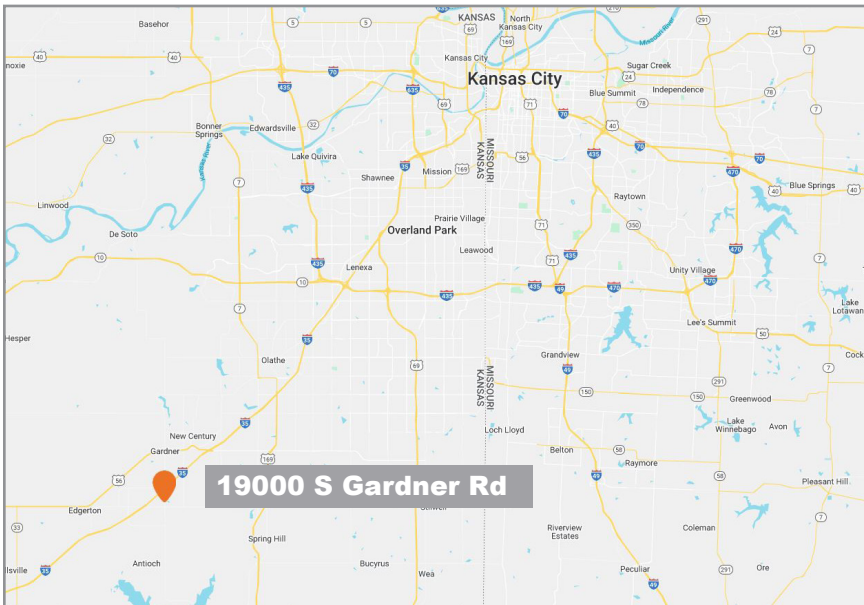

For more information:

Christian Wead
816.412.8472
cwead@blockllc.com

Michael R. Block, CPM
816.932.5549
mblock@blockllc.com