

58 Highway Development Pad For Sale



Sale Price: \$1,000,000 | 24,590 SF Lot

For more information:

- 24,590 SF pad site for sale
- Prime frontage and exposure to 58 Highway
- Over 38,220 cars per day pass by this site
- Excellent development site for restaurant or retail user
- Very active corridor with heavy sales volumes

Andrew Block
Principal
816.412.5873
ablock@blockllc.com

The information contained in this marketing flyer is presented as general information only. Block Real Estate Services, LLC makes no representation as to its accuracy. This information is not intended as legal, financial or real estate advice and must not be relied upon as such. You should make your own inquiries, obtain independent inspections, and seek professional advice tailored to your specific circumstances before making any legal, financial or real estate decisions.

Demographics

| 8019 E 171st St Belton, MO 64012 | 1 mi radius | 3 mi radius | 5 mi radius |
|---|----------------|----------------|----------------|
| Population | | | |
| 2025 Estimated Population | 9,366 | 51,060 | 68,919 |
| 2030 Projected Population | 10,621 | 56,695 | 75,107 |
| 2020 Census Population | 7,149 | 46,967 | 64,277 |
| 2010 Census Population | 6,525 | 42,083 | 58,423 |
| Projected Annual Growth 2025 to 2030 | 2.7% | 2.2% | 1.8% |
| Historical Annual Growth 2010 to 2025 | 2.9% | 1.4% | 1.2% |
| 2025 Median Age | 39.4 | 37.5 | 37.5 |
| Households | | | |
| 2025 Estimated Households | 3,730 | 20,345 | 27,081 |
| 2030 Projected Households | 4,277 | 22,850 | 29,859 |
| 2020 Census Households | 2,891 | 18,013 | 24,521 |
| 2010 Census Households | 2,521 | 15,765 | 21,811 |
| Projected Annual Growth 2025 to 2030 | 2.9% | 2.5% | 2.1% |
| Historical Annual Growth 2010 to 2025 | 3.2% | 1.9% | 1.6% |
| Race and Ethnicity | | | |
| 2025 Estimated White | 76.3% | 77.9% | 74.4% |
| 2025 Estimated Black or African American | 13.3% | 12.2% | 14.8% |
| 2025 Estimated Asian or Pacific Islander | 2.4% | 1.5% | 1.5% |
| 2025 Estimated American Indian or Native Alaskan | 0.5% | 0.4% | 0.4% |
| 2025 Estimated Other Races | 7.6% | 8.0% | 8.9% |
| 2025 Estimated Hispanic | 7.8% | 7.6% | 8.5% |
| Income | | | |
| 2025 Estimated Average Household Income | \$96,798 | \$106,071 | \$103,759 |
| 2025 Estimated Median Household Income | \$81,600 | \$87,405 | \$85,098 |
| 2025 Estimated Per Capita Income | \$38,642 | \$42,306 | \$40,815 |
| Education (Age 25+) | | | |
| 2025 Estimated Elementary (Grade Level 0 to 8) | 2.1% | 2.9% | 2.8% |
| 2025 Estimated Some High School (Grade Level 9 to 11) | 4.5% | 3.7% | 4.3% |
| 2025 Estimated High School Graduate | 31.9% | 29.5% | 29.5% |
| 2025 Estimated Some College | 26.1% | 23.9% | 24.1% |
| 2025 Estimated Associates Degree Only | 7.2% | 8.0% | 8.1% |
| 2025 Estimated Bachelors Degree Only | 18.1% | 21.4% | 20.8% |
| 2025 Estimated Graduate Degree | 10.1% | 10.7% | 10.4% |
| Business | | | |
| 2025 Estimated Total Businesses | 254 | 1,078 | 1,496 |
| 2025 Estimated Total Employees | 2,625 | 13,296 | 20,125 |
| 2025 Estimated Employee Population per Business | 10.4 | 12.3 | 13.5 |
| 2025 Estimated Residential Population per Business | 36.9 | 47.3 | 46.1 |

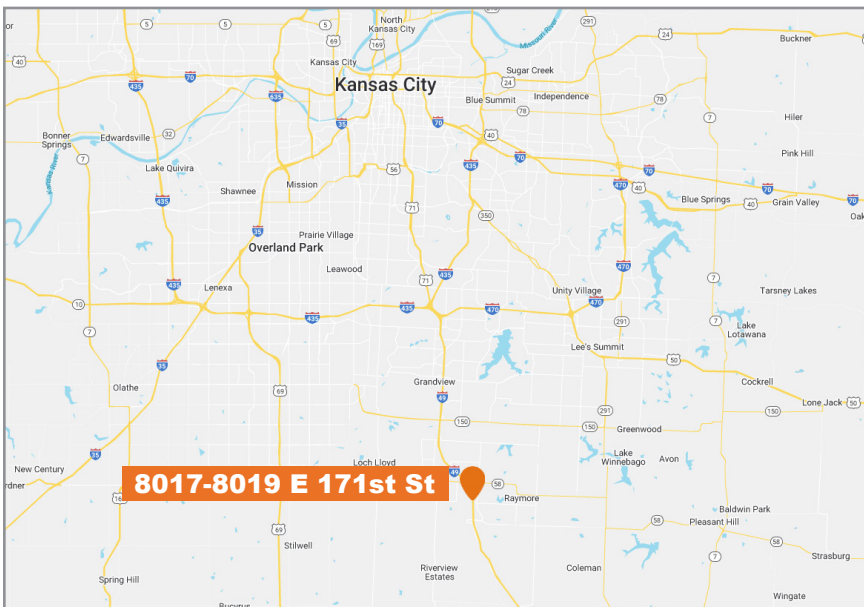
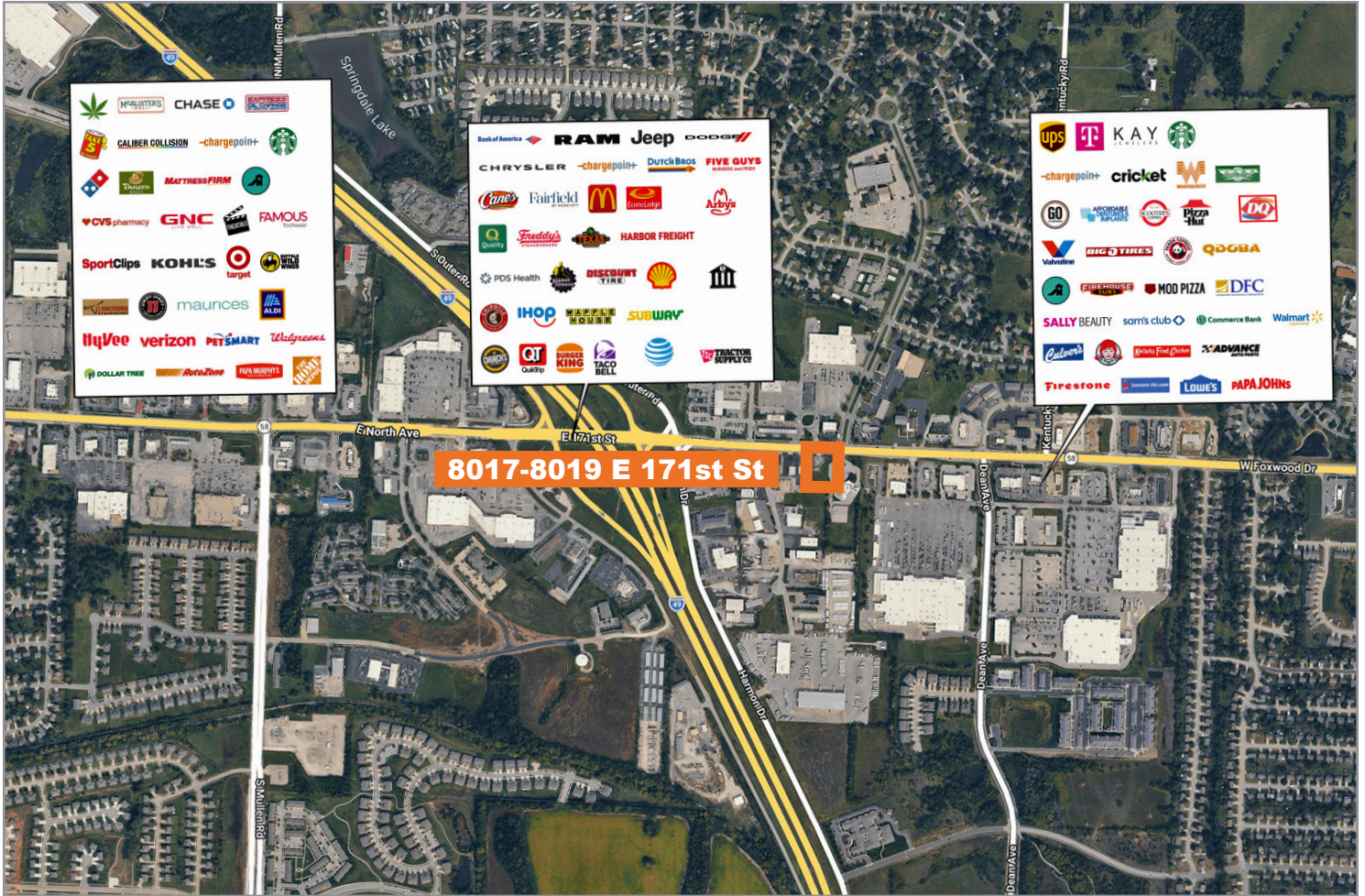

For more information:

Andrew Block
Principal
816.412.5873
ablock@blockllc.com