

Riverside Industrial Center #2

124 NW Business Park Lane, Riverside, Missouri

For Lease



Excellent Site

- 6,000 SF with 1 drive-in door
- 5,500 SF office
- Interstate access to I-35, I-29 & I-635
- Centrally located
- No city earnings tax

For more information:

Zach Hubbard, SIOR
816.932.5504
zhubbard@blockllc.com

Hagen Vogel
816.878.6338
hvogel@blockllc.com

The information contained in this marketing flyer is presented as general information only. Block Real Estate Services, LLC. makes no representation as to its accuracy. This information is not intended as legal, financial or real estate advice and must not be relied upon as such. You should make your own inquiries, obtain independent inspections, and seek professional advice tailored to your specific circumstances before making any legal, financial or real estate decisions.

Building Specifications

Square Feet Available: 6,000 SF

Office Space: 5,500 SF

Total Building Square Feet: 44,000 SF

Loading: 1 door (grade level)

Lighting: Metal Halide

Year Built: 1985

Clear Height: 18'

Column Spacing: 32' x 32' (typical)

Floor Type: 6" thick - reinforced concrete

Sprinkler: Wet system

Electric Service: 200 amp, 120/208 v, 3ph

Type of Lease: Net, Net

Offering Rate: \$6.00 PSF

Net Charge: (2024 Estimates)	CAM:	\$1.15 PSF
	Taxes:	\$1.33 PSF
	<u>Insurance:</u>	<u>\$0.22 PSF</u>
	Total:	\$2.70 PSF

Riverside Industrial Center #2

124 NW Business Park Lane, Riverside, Missouri

For Lease

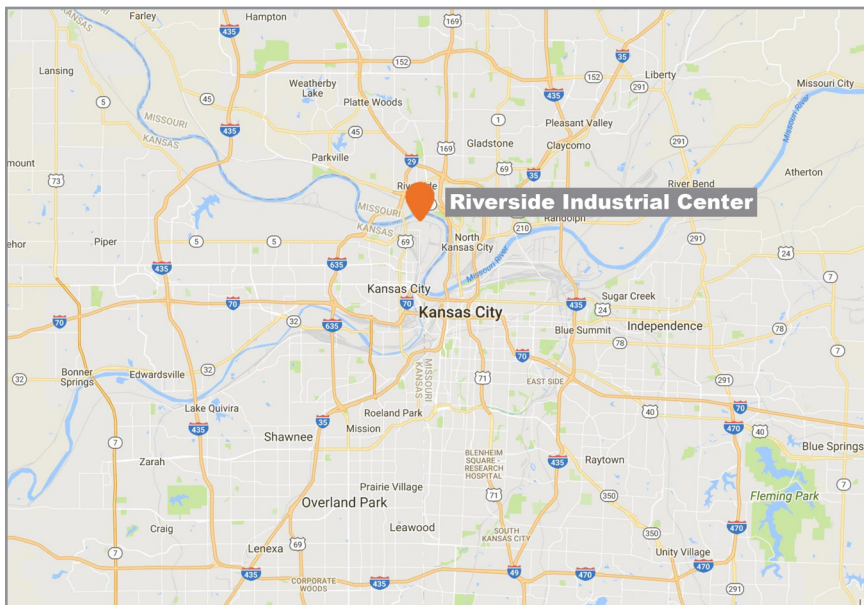

For more information:

Zach Hubbard, SIOR
816.932.5504
zhu Hubbard@blockllc.com

Hagen Vogel
816.878.6338
hvogel@blockllc.com

4622 Pennsylvania Avenue, Suite 700
Kansas City, MO 64112
816.756.1400 | www.BLOCKLLC.com

BLOCK
REAL ESTATE SERVICES, LLC

Riverside Industrial Center #2

124 NW Business Park Lane, Riverside, Missouri

For Lease

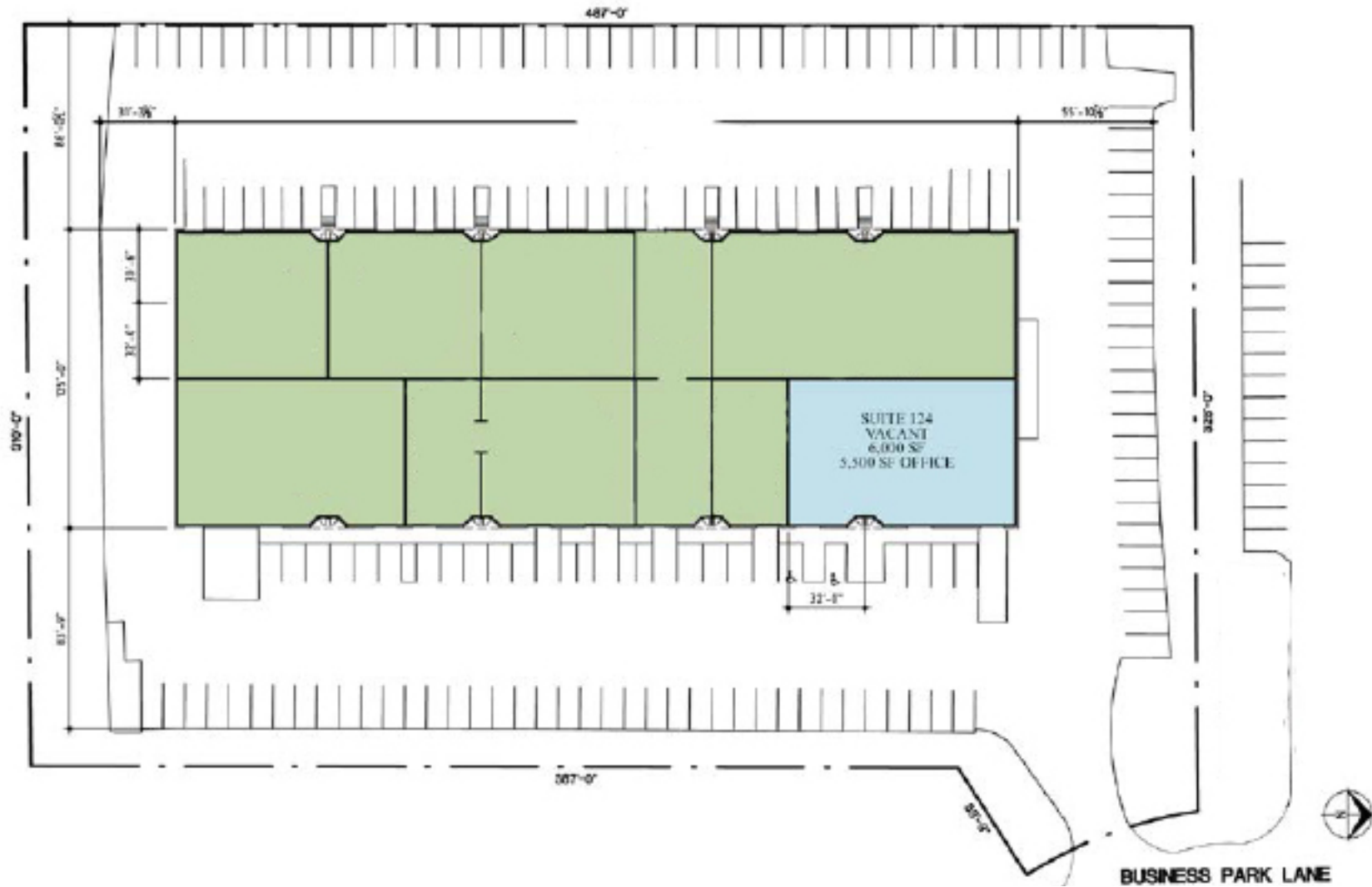

4622 Pennsylvania Avenue, Suite 700
Kansas City, MO 64112
816.756.1400 | www.BLOCKLLC.com

BLOCK
REAL ESTATE SERVICES, LLC

Riverside Industrial Center #2

124 NW Business Park Lane, Riverside, Missouri

For Lease

