

Excellent Access & Location
Situated in the highly desirable Johnson County submarket



Prestigious Mixed-Use Business Park

- Excellent access and location in the highly-desirable Johnson County submarket
- 15 minutes from downtown Kansas City and less than 30 minutes from the Kansas City International Airport
- Ample parking which is designed with spaces close to building entrances

For more information:

Kenneth G. Block, SIOR, CCIM
816.932.5551
kblock@blockllc.com

Andrew T. Block
816.412.5873
ablock@blockllc.com

Hagen Vogel
816.878.6338
hvogel@blockllc.com

The information contained in this marketing flyer is presented as general information only. Block Real Estate Services, LLC. makes no representation as to its accuracy. This information is not intended as legal, financial or real estate advice and must not be relied upon as such. You should make your own inquiries, obtain independent inspections, and seek professional advice tailored to your specific circumstances before making any legal, financial or real estate decisions.

General Building Information

Location:	8055-8071 Flint Street, Lenexa, Kansas
Building Size:	One Story Building; 50,032 SF
Parking Ratio:	149 Surface Spaces. 2.98/1,000 Square Feet
Design Features:	This multi-tenant facility is designed to accommodate those users seeking 7,500 square feet and up which require drive-in loading
Building Construction:	Precast concrete panels and glass
Zoning:	BP-2
Loading:	Drive-in and dock-high loading
Clear Height:	20'
Utilities (Lessee):	Electricity - Kansas City Power and Light Gas - KPL Gas Services Water - Water District #1 of Johnson County

For more information:

Kenneth G. Block, SIOR, CCIM
816.932.5551
kblock@blockllc.com

Andrew T. Block
816.412.5873
ablock@blockllc.com

Hagen Vogel
816.878.6338
hvogel@blockllc.com

13,874 SF

Space Available:	8065 Flint Street, Lenexa, Kansas
SF Available:	13,874 SF total 3,529 SF office 10,345 SF warehouse
Design Features:	This multi-tenant facility is designed to accommodate those users seeking 13,000 square feet and up which require drive-in loading
Electrical Service:	(2) 120/208v, 3-Phase, 200AMP Services
Loading:	3 drive-in & 3 dock-high
Clear Height:	20'
Zoning:	BP-2
Base Rent:	\$7.50 PSF Net, increasing 2% per year
Common Area Maintenance:	Approximately \$2.33 per square foot
Est. Real Estate Tax:	\$3.20 PSF (Est.)
Est. Insurance:	\$0.20 PSF (Est.)
Est. Park Maintenance:	Maximum \$0.08 per foot

For more information:

Kenneth G. Block, SIOR, CCIM
816.932.5551
kblock@blockllc.com

Andrew T. Block
816.412.5873
ablock@blockllc.com

Hagen Vogel
816.878.6338
hvogel@blockllc.com

Building 19

8055-8071 Flint Street

Floor Plan

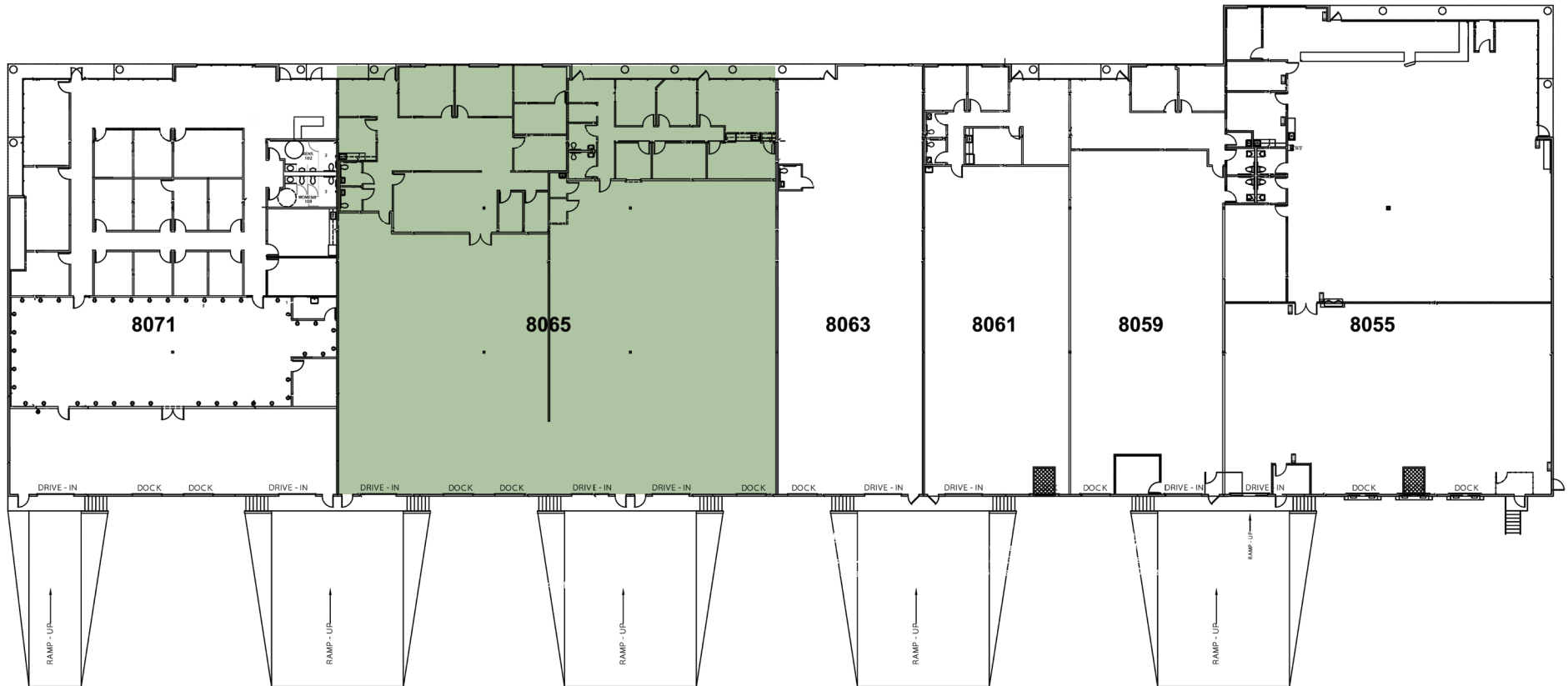

1 floor plan
scale: 1/16" = 1'-0"
north