



Development Opportunity at Midwestern Intermodal Hub

- Immediately across the street from the main entrance to BNSF's Kansas City Intermodal Facility, a 1,000-acre rail and truck distribution hub
- Adjacent to 700,000 SF UPS & Horizon Global with 1.5 million square feet under development
- Approximately 36 Acres available immediately outside of BNSF Main Gate
- Utilities are on site

For more information:

Kim Bartalos, CLS
816.412.8466
kbartalos@blockllc.com

The information contained in this marketing flyer is presented as general information only. Block Real Estate Services, LLC. makes no representation as to its accuracy. This information is not intended as legal, financial or real estate advice and must not be relied upon as such. You should make your own inquiries, obtain independent inspections, and seek professional advice tailored to your specific circumstances before making any legal, financial or real estate decisions.

Kansas City Intermodal

SWC of 191st & Homestead, Edgerton, Kansas

Development Opportunity

Concept Plan

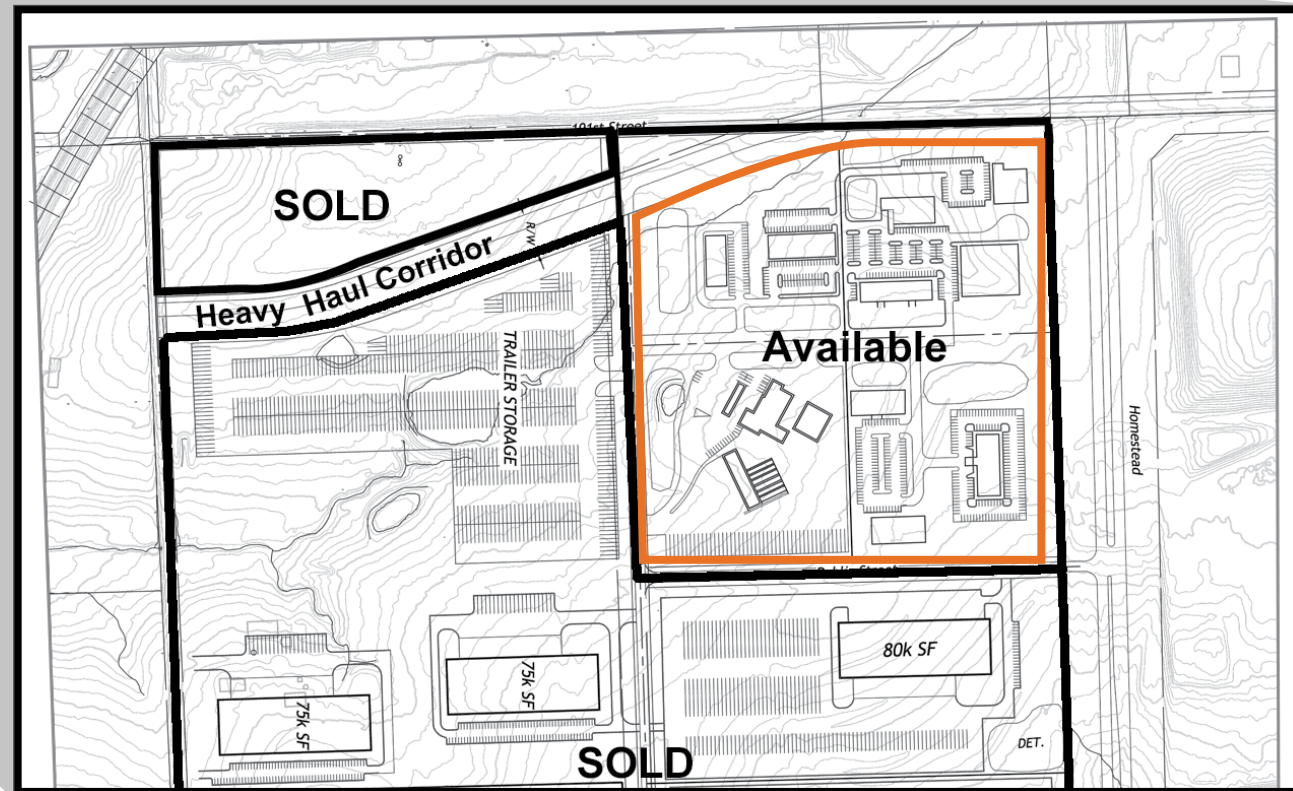
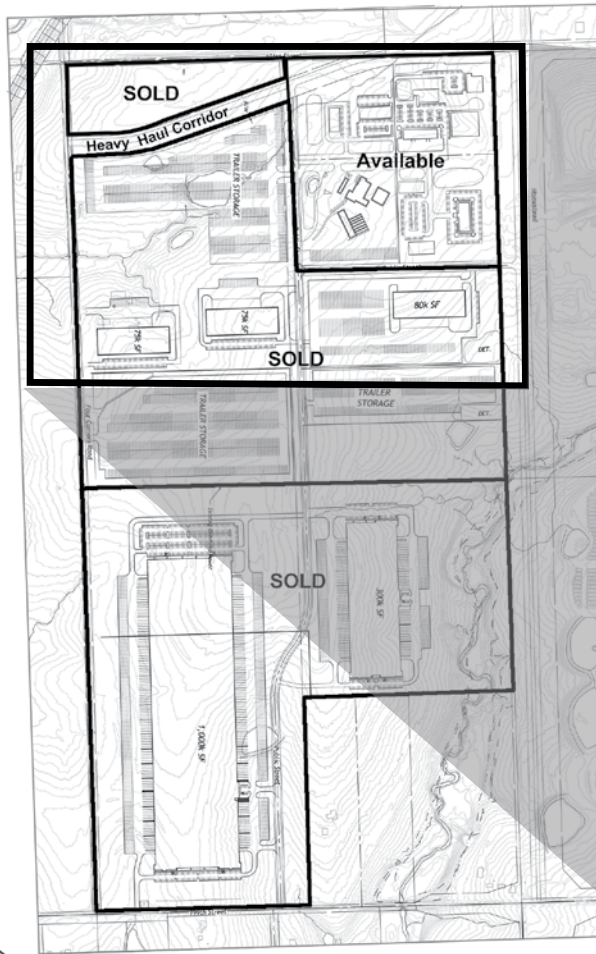

Kansas City Intermodal

SWC of 191st & Homestead, Edgerton, Kansas

Development
Opportunity

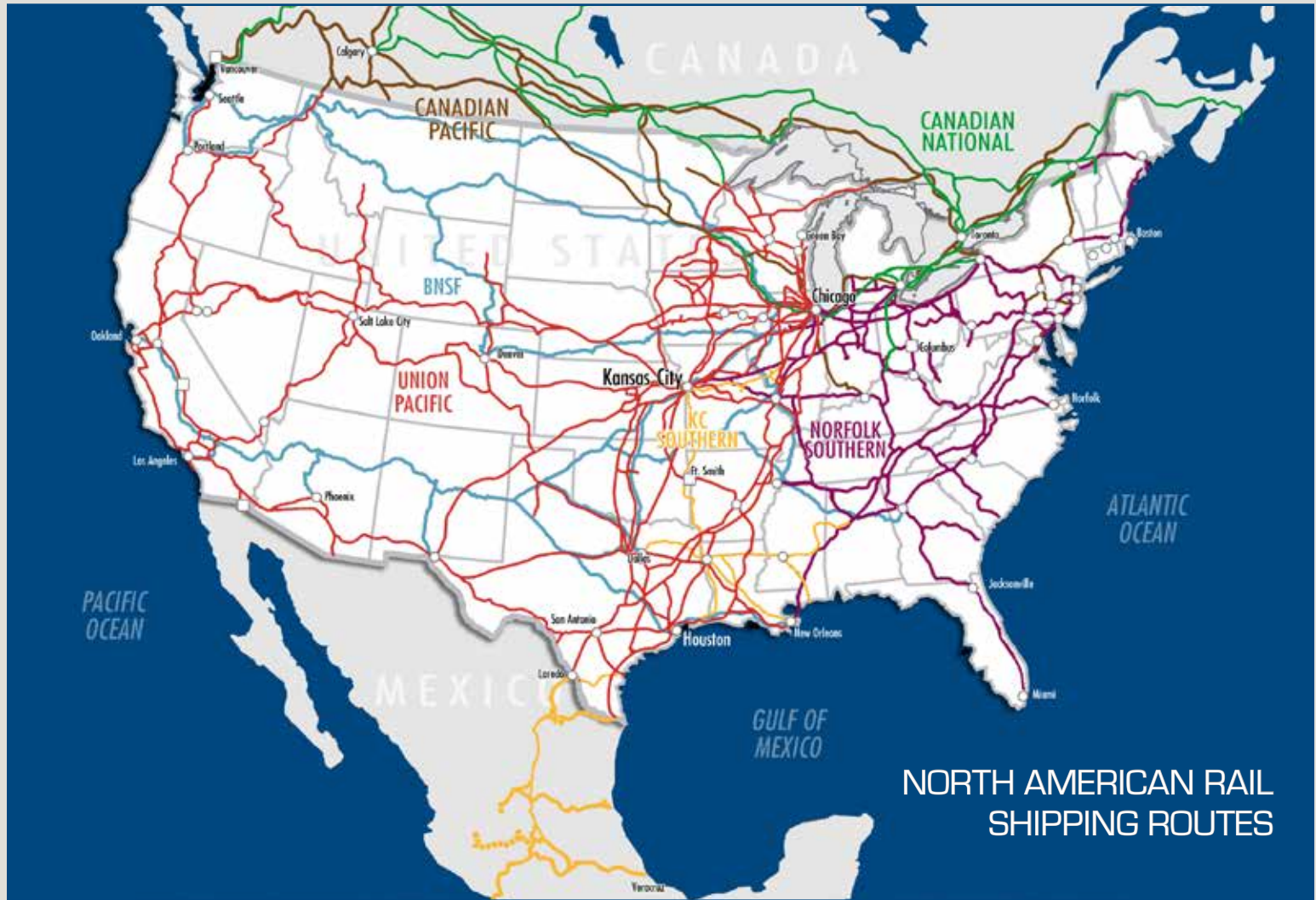

For more information:

Kim Bartalos, CLS
816.412.8466
kbartalos@blockllc.com